

Profit

PRODUCT CATALOGUE

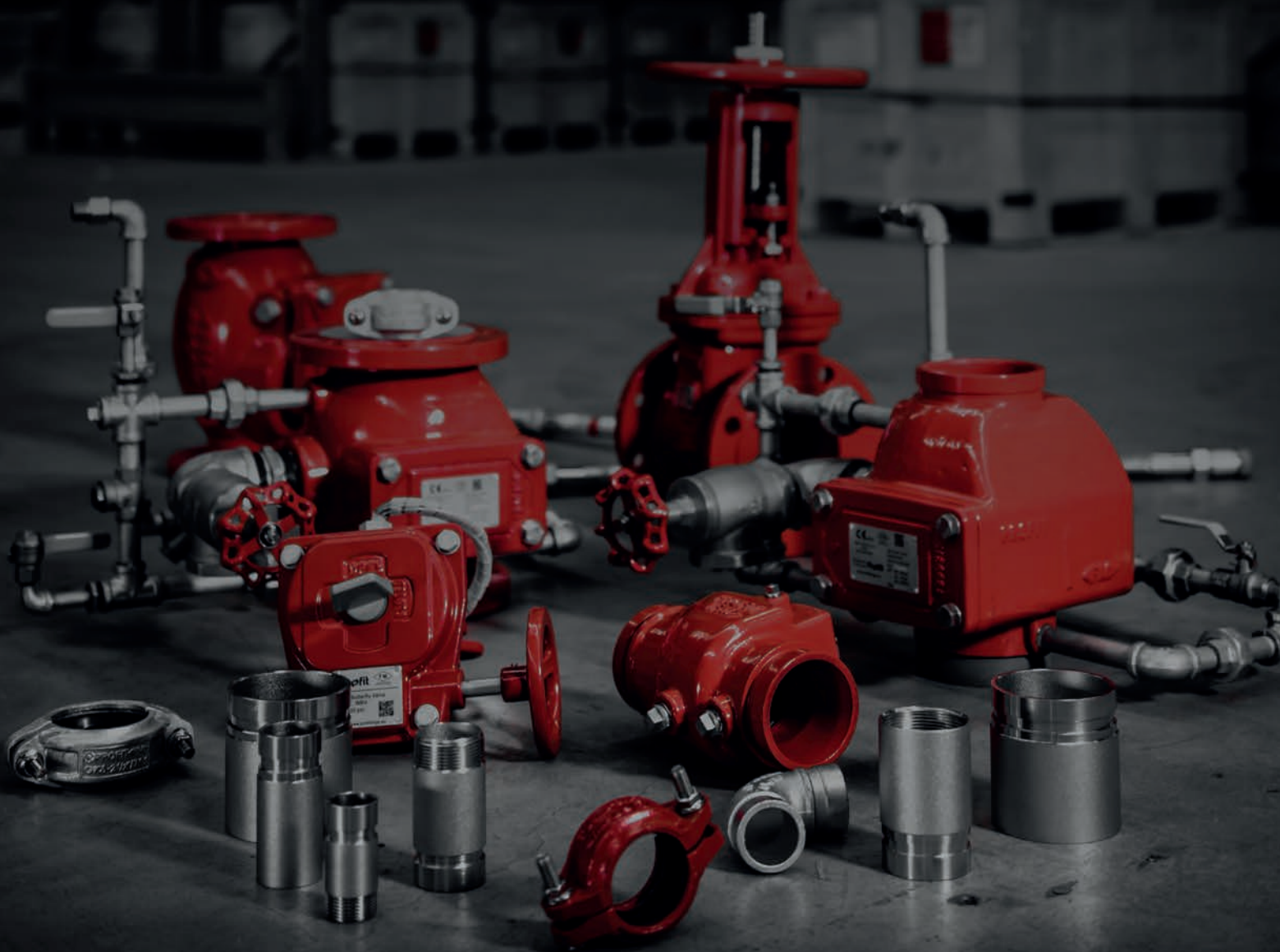

ABOUT PROFIT	4
REFERENCES	5
QUALITY	8
CERTIFICATIONS	10
MARKETS	11
VALVES	12
BUTTERFLY VALVE GROOVED END	13
BUTTERFLY VALVE WAFER END	14
OS&Y FLANGED GATE VALVE	15
GROOVED CHECK VALVE	16
FLANGED CHECK VALVE	17
DOUBLE DOOR WAFER CHECK VALVE	18
WET ALARM VALVE FLANGED WITH TRIM	19
WET ALARM VALVE GROOVED WITH TRIM	20
MOTOR GONG FOR ALARM VALVES	21
PROFLEX FLEXIBLE SPRINKLER HOSES	22
UNBRAIDED FLEXIBLE HOSE SETS	23
BRAIDED FLEXIBLE HOSE SETS	24
FLEXIBLE HOSE PARTS	25
COUPLINGS & FITTINGS	26
ANGLE-PAD RIGID COUPLING	27
GROOVED RIGID COUPLING	28
GROOVED FLEXIBLE COUPLING	29
GROOVED RIGID COUPLING ANGLE-PAD	30
REDUCING COUPLING WITH STEEL RING	31
U-BOLT SPRINKLER TEE THREADED BSPT OUTLET	32
FULL CASTING SPRINKLER TEE THREADED BSPT OUTLET	33
MECHANICAL TEE GROOVED OUTLET	34
MECHANICAL TEE THREADED BSPT OUTLET	36
GROOVED ELBOW 11,25°	38
GROOVED ELBOW 22,50°	39
GROOVED ELBOW 45°	40
GROOVED ELBOW 90°	41
GROOVED REDUCING ELBOW 90°	42
GROOVED DRAIN ELBOW 90°	43
GROOVED EQUAL TEE	44
GROOVED EQUAL CROSS	45
GROOVED CONCENTRIC REDUCER	46
THREADED CONCENTRIC REDUCTION	48
GROOVED REDUCING TEE	50
THREADED REDUCING TEE	52
GROOVED END CAP	54
GROOVED END CAP WITH ECCENTRIC HOLE, THREADED BSPT OUTLET	55
GROOVED ADAPTER FLANGE	56
GROOVED SPLIT ADAPTER FLANGE	57
GROOVED THREADED ADAPTER, MALE THREAD BSPT	58
GROOVED THREADED ADAPTER, FEMALE THREAD BSPT	59
GROOVED PRODUCTS • MATERIALS	60
ACCESSORIES	61
LUBRICANT	62
GROOVE METER	63
GLOVES	63
CENTER PUNCH TOOL	64
PRESSURE GAUGE	64
NOTES	65



Piping Logistics is a customer-oriented organisation that provides service in more than 7 different languages. We know each of our customers and therefore, we provide the best service to all clients according to their needs. You can count on us for flexible solutions, technical knowledge and correct administration. With Piping Logistics we produce and supply components for Sprinkler (FIRE) and HVAC installations. Our business model consists in establishing long-term partnerships with our customers, keeping one of the largest stocks in Europe and providing excellent aftersales service and favorable sales conditions. With our privileged location in the center of Europe, we strive for just-in-time deliveries.

The "PROFIT" brand is already well known in the fire protection industry market since 15 years and recently we are making our name in the HVAC industry as well. Nowadays the Profit brand consists of a wide range of grooved fittings, couplings and accessories combined with a growing range of valves and hoses. The company consists of our administrative offices, warehouse, QC department at production sites and own R&D Engineering Department. From this R&D Department we focus on design and development of our own Profit Branded products. The strategy of Piping Logistics is to provide our customers with the best possible products for their installations.

MISSION

Piping Logistics aim is to be the European specialist with own self-designed (cast iron) grooved fitting products for the piping market. As independent player in the center of Europe's crossroads, we want to be the best possible partner for a wide range of components in different pipe systems.

VISION

Our goal is to become the specialist (high value) in Europe, offering a complete gamma of products (grooved fittings + side-products) necessary for a piping installation, within a wide range of sectors. Our vision is to supply customers with products of high quality at a correct price where the availability and flexibility is our major asset.

TODAY, PROFIT IS ACTIVE IN MORE THAN 36 COUNTRIES, FOCUSING ON BUILDING LONG-LASTING RELATIONSHIPS WITH ITS PARTNERS IN THE FIRE PROTECTION INDUSTRY.



Hereby a highlight of some of our references. Please contact our sales or customer department to receive more references.



ATATÜRK AIRPORT, ISTANBUL, TURKEY



DHG SMARTLOG MAASVLAKTE, ROTTERDAM, THE NETHERLANDS

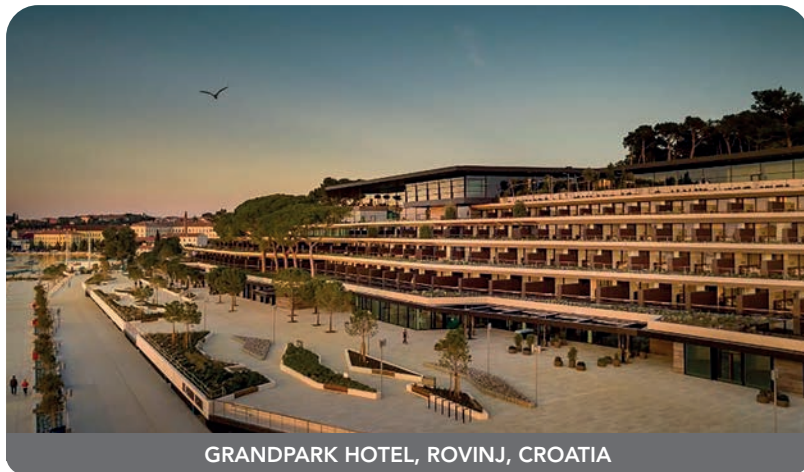

GRANDPARK HOTEL, ROVINJ, CROATIA



AIRPORT JOHN PAUL II, BALICE, POLAND



BOZSIK STADIUM, BUDAPEST, HUNGARY



NIKE LOGISTICS CENTRE, LAAKDAL, BELGIUM



MALL OF SFAK, SFAK, TUNIS

REFERENCES



REGIONAL HOSPITAL OF LIEPAJA, LATVIA



LIDL DISTRIBUTION CENTRE, ECSER, HUNGARY



GIRANDELLA RESORT, RABAC, CROATIA

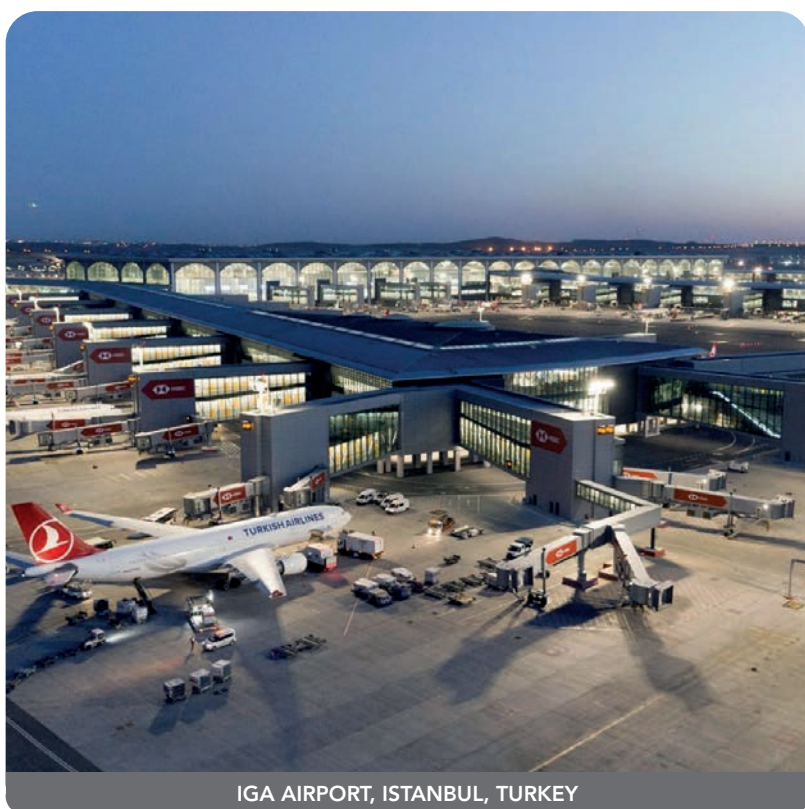

IGA AIRPORT, ISTANBUL, TURKEY



NESTLÉ PRODUCTION CENTRE, BÜK, HUNGARY



TRILOGIPORT, LIEGE, BELGIUM



GALLERIA SANTA LUCIA, ITALY



ALIBABA LOGISTICS CENTRE, LIEGE AIRPORT, BELGIUM



OCEAN PLAZA MALL, KIEV, UKRAINE



HILTON TALLINN PARK HOTEL, ESTONIA



AMAZON WAREHOUSE, MILANO, ITALY



HOLLISTER MANUFACTURING, KAUNAS, LITHUANIA

WE CARE FOR OUR CUSTOMERS, WE AIM FOR ZERO PRODUCT DEFECTS, WE DELIVER THE REQUIRED QUALITY.

We have established extensive quality control systems both upstream and downstream.

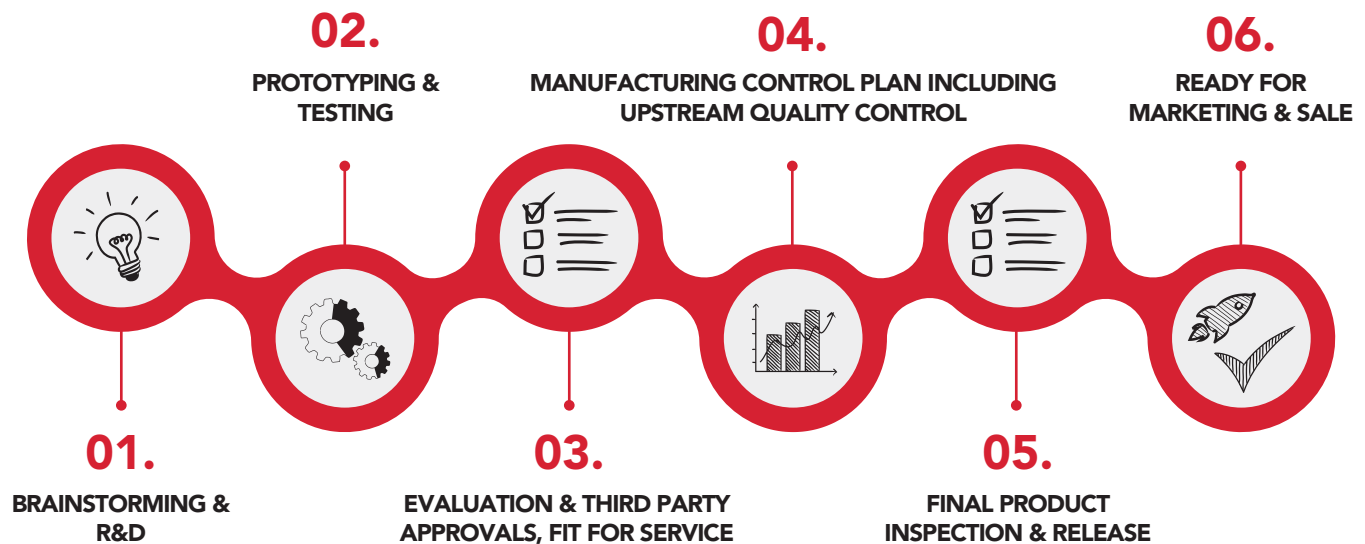

Profit QC engineers are resident at our subcontractor manufacturing sites focusing to safeguard the quality of all parts, products & assemblies and strive to improve and find sustainable methods of manufacturing, applying our internal high quality standards.

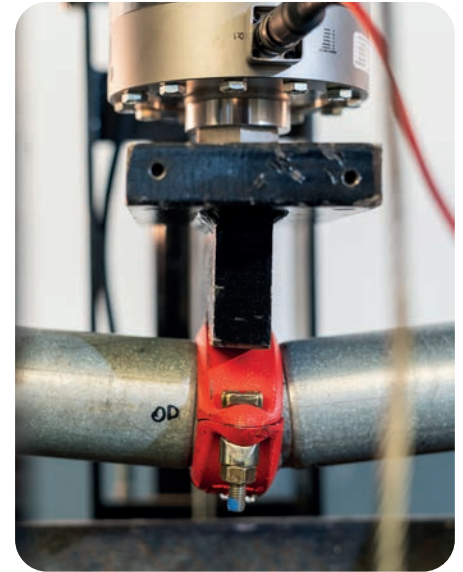

In Europe, a team of engineers is active in the R & D department, including an extended laboratory to perform all necessary tests to guarantee an exceptional quality performance. We continuously search and develop new products and assess new suppliers products before marketing.

SOME OF THE TESTS THAT WE CAN CONDUCT ARE LISTED BELOW:

- Microscopic analysis (nodularity & matrix) of the cast iron, including software-analysis.
- Low pressure pneumatic leakage test.
- High pressure hydraulic pressure test.
- Coupling bending tests under high pressure (FM, UL & VdS).
- Shore A - rubber hardness test.
- Ultrasonic nodularity test.
- Paint and galvanization coating thickness test.
- Salt spray corrosion-test.
- Hot and cold gasket rubber aging test in climate-chamber.
- Rubber compression test.
- Rubber tensile test.
- Rubber elongation test.
- Proof load test for nuts & bolts.
- Frost simulation test in climate-chamber.





ISO 9001:2015

ISO 9001:2015 is a quality management system standard.



[VIEW OUR ISO CERTIFICATE](#)



FM APPROVED

FM Approvals is an independent organization that sets the standard in third-party certification in fire protection.



[VIEW OUR FM APPROVALS](#)



UL CERTIFIED

UL is a global independent safety science company which guarantees the safety of among others fire protection products.



[VIEW OUR UL CERTIFICATIONS](#)



CNBOP APPROVED

The CNBOP technical approval contains the technical specifications for the process of conformity assessment and issuing of a certificate or declaration of conformity.



[VIEW OUR CNBOP APPROVALS](#)



VDS CERTIFIED

VdS is a German independent testing institution which executes certification for products (components, equipment and systems) in the areas of fire protection and safety technology.



[VIEW OUR VDS CERTIFICATIONS](#)



CNPP CERTIFIED

CNPP certified is a French certification that guarantees compliance with the standards for security systems.



[VIEW OUR CNPP CERTIFICATIONS](#)



EAC CERTIFIED

The Eurasian Conformity mark (EAC) is a certification mark to indicate products that conform to all technical regulations of the Eurasian Customs Union.



[VIEW OUR EAC CERTIFICATIONS](#)



CE MARKING

The CE Marking serves as a declaration from the manufacturer that their product complies with the essential requirements of the relevant European health, safety and environmental legislation laid out in the different product directives.



[VIEW OUR CE MARKINGS](#)



CSTB CERTIFIED

The Centre Scientifique et Technique du Bâtiment (Scientific and Technical Center for Building) CSTB, is the French national organisation providing research and innovation, consultancy, testing, training and certification services in the construction industry.



[VIEW OUR CSTB CERTIFICATIONS](#)



FIRE PROTECTION

Wet & dry sprinkler piping installations used in:

- Industrial storage & installations.
- Hotels & leisure centres.
- Warehousing.
- Hospitals.
- Healthcare & sports facilities.
- Residential.
- Public transport & airports.



HEATING, VENTILATION AND AIR CONDITIONING

- Cooling systems.
- Heating systems.
- Glass houses.
- Air conditioning systems.
- Compressed air networks.
- Heat pump systems.
- Boilers.
- Refrigeration systems.
- Solar combi systems.



VALVES



BUTTERFLY VALVE GROOVED END • GBV



DATASHEET

Profit butterfly valves type GBV are indicating valves. They have a grooved in-and outlet and for installation the use of two Profit rigid couplings is recommended. The valves are designed to be used in fire protection sprinkler systems.

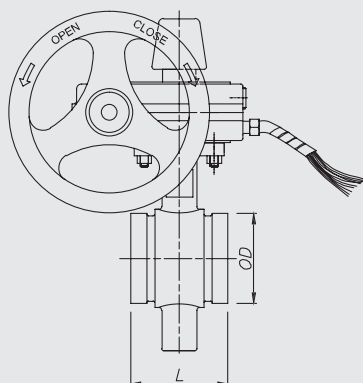

Dimensions (mm)

Reference	Size	OD	L
GBV2	2"	60,3	84
GBV2½	2,5"	73,0 / 76,1	97
GBV3	3"	88,9	97
GBV4	4"	114,3	116
GBV5	5"	139,7 / 141,3	148
GBV6	6"	165,1 / 168,3	148
GBV8	8"	219,1	133
GBV10*	10"	273,1	159
GBV12*	12"	323,9	165

* ONLY AVAILABLE IN CONTAINER DIRECTLY FROM FACTORY.



- Indoor use.
- Manually operated with external gearbox with open/close directions on handwheel.
- Yellow open/close position indicator.
- Two built-in micro-switches, pre-wired.
- E/E dimension comply with MSS SP-67.
- Grooved ends acc. AWWA C606 standard.
- Installation by use of two rigid mechanical couplings.
- Anti-corrosion protection : high grade polyester powder coating, RAL 3000, meets or exceed AWWA C550 standards.



BUTTERFLY VALVE WAFER END • WBV

EAC

FM
APPROVED

DATASHEET

Profit butterfly valves type WBV are indicating valves. The wafer type body has vulcanised full face rubber gaskets and is installed between flanges. The valves are designed to be used in fire protection sprinkler systems.

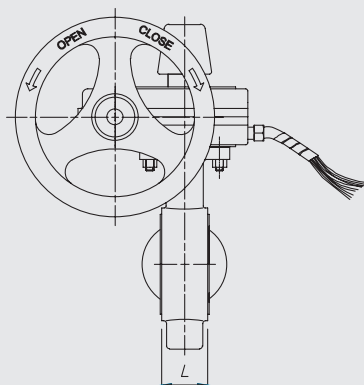

Dimensions (mm)

Reference	Size	L
WBV2	2"	43
WBV2½	2,5"	46
WBV3	3"	46
WBV4	4"	51,5
WBV5	5"	56
WBV6	6"	56,5
WBV8	8"	60
WBV10*	10"	68,5
WBV12*	12"	79,5

* ONLY AVAILABLE IN CONTAINER DIRECTLY FROM FACTORY.



- Indoor use.
- Manually operated with external gearbox with open/close directions on handwheel.
- Yellow open/close position indicator.
- Two built-in micro-switches, pre-wired.
- Valve body features 4 bolt-holes for easy mounting.
- F/F dimension comply with EN 558/series20 and ASME B16.10/narrow.
- Installation between flange-types EN 1092/PN10/PN16 and ASTM B16.5 Class 150/Class125.
- Anti-corrosion protection: high grade polyester powder coating, RAL 3000, meets or exceed AWWA C550 standards.



OS&Y FLANGED GATE VALVE • FGOSY



DATASHEET

Profit gate valves type FGOSY are resilient seated gate valves. The flanged cast iron body has a ductile iron wedge with vulcanised rubber lining. The valves are designed to be used in fire protection sprinkler systems.

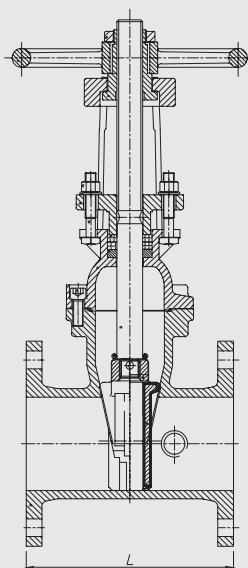

Dimensions (mm)

Reference	Size	L
FGOSY2*	2"	178 / 7,0
FGOSY2½*	2,5"	190 / 7,5
FGOSY3*	3"	203 / 8,0
FGOSY4	4"	229 / 9,0
FGOSY6	6"	267 / 10,5
FGOSY8	8"	292 / 11,5
FGOSY10	10"	330 / 13,0
FGOSY12	12"	356 / 14,0

* ONLY AVAILABLE IN CONTAINER DIRECTLY FROM FACTORY.



- Indoor & outdoor use.
- Manually operated with a hand-wheel.
- Installation between flange-types EN 1092-PN10/16:
 - DN50 to DN150: PN 10/16.
 - DN200 to DN300: PN16.
- F/F dimension comply with EN 558/series3, ASME B16.10 and ISO 5752.
- Full bore waterway body.
- Resilient wedge.
- Suitable for use in vertical and horizontal piping.
- Anti-corrosion protection : high grade polyester powder coating, RAL 3000, meets or exceed AWWA C550 standards.
- Pre-notched stem to accomodate an (optional) supervisory switch.

GROOVED CHECK VALVE • GCV

EAC



DATASHEET

Profit check valves type GCV are swing-type valves that allow water flow in one direction. They have a grooved in- and outlet and for installation we recommend the use of two Profit mechanical couplings. The valves are designed to be used in fire protection sprinkler systems.

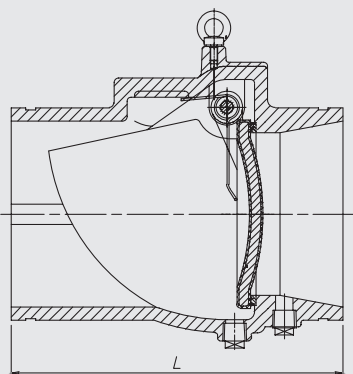

Dimensions (mm/inch)

Reference	Size	L
GCV2	2"	190 / 7,5
GCV2½	2,5"	203 / 8,0
GCV3	3"	213 / 8,38
GCV4	4"	245 / 9,65
GCV5	5"	267 / 10,5
GCV6	6"	292 / 11,5
GCV8	8"	356 / 14,0
GCV10	10"	432 / 17,0
GCV12	12"	495 / 19,5



- Indoor use.
- Resilient seating. The swing-disc is fully encapsulated with EPDM-rubber.
- Spring loaded disc for fast closure and to minimize water hammer.
- Grooved ends according to AWWA C606 standard.
- Including two plugged drain connections.
- Installation in vertical flow (upwards) and horizontal pipes is allowed.
- Installation by use of two rigid mechanical couplings.
- Very low pressure losses, even at high flow rates.
- Anti-corrosion protection: high grade polyester powder coating RAL 3000, meets or exceed AWWA C550 standards.



FLANGED CHECK VALVE • FCV



DATASHEET

Profit check valves type FCV are swing-type valves that allow water flow in one direction. They have a fixed flange on the in-and outlet. The valves are designed to be used in fire protection sprinkler systems.

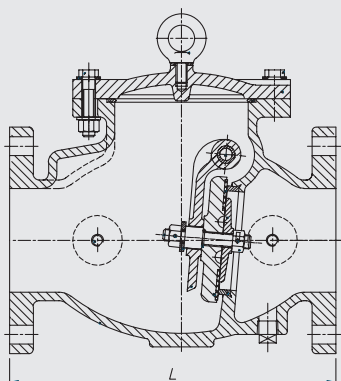

Dimensions (mm/inch)

Reference	Size	L
FCV2*	2"	203 / 8,0
FCV2½*	2,5"	254 / 10,0
FCV3	3"	279 / 11,0
FCV4	4"	330 / 13,0
FCV5*	5"	356 / 14,0
FCV6	6"	406 / 16,0
FCV8	8"	495 / 19,5
FCV10	10"	559 / 22,0
FCV12	12"	660 / 26,0

* ONLY AVAILABLE IN CONTAINER DIRECTLY FROM FACTORY.



- Indoor use.
- Resilient seating with EPDM-rubber against a bronze ring.
- Gravity operated, swing check design.
- Flanged ends according to EN 1092-2/PN16 standard.
- Meets the AWWA C 508 standard.
- Including two plugged side-connections and one bottom drain connection.
- Eye bolt for lifting on bigger sizes (6"-12").
- Installation in vertical flow (upwards) and horizontal pipes is allowed.
- Very low pressure losses, even at high flow rates.
- Anti-corrosion protection : high grade polyester powder coating, RAL 3000, meets or exceed AWWA C550 standards.
- Equipped with a maintenance hatch.



DOUBLE DOOR WAFER CHECK VALVE • WCV

EAC



DATASHEET

Profit check valves type WCV are swing-type twin disc check valves that allow water flow in one direction. The valves are designed to be used in fire protection sprinkler systems.

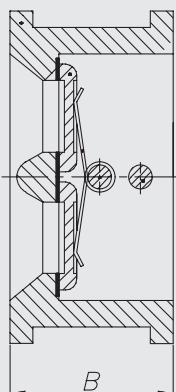

Dimensions (mm)

Reference	DN		B
	mm	inch	
WCV-16-4	100	4	64
WCV-16-6	150	6	76
WCV-16-8	200	8	95
WCV-16-10	250	10	108
WCV-16-12	300	12	143



- In- and outdoor use.
- Resilient seating for perfect tightness, also at low differential pressure.
- Double door check valve system.
- Spring assisted disc for excellent dynamic behaviour.
- Short face to face dimensions and compact design.
- Installation in vertical and horizontal pipes is allowed.
- Installation by use of two extra gaskets between pipe-flanges, flange types: EN 1092/PN10/PN16 and ANSI B16.1/Class 125/Class 150.
- Anti-corrosion protection : high grade polyester powder coating, RAL 3000.



WET ALARM VALVE FLANGED WITH TRIM • FACV



DATASHEET

Profit wet alarm check valves are swing-type check valves that allow water flow in one direction. They automatically actuate an electric or hydraulic alarm when one or more sprinkler-heads are activated. Type FACV has a fixed flange on the in-and outlet. The valves are designed to be used in WET fire protection sprinkler systems.

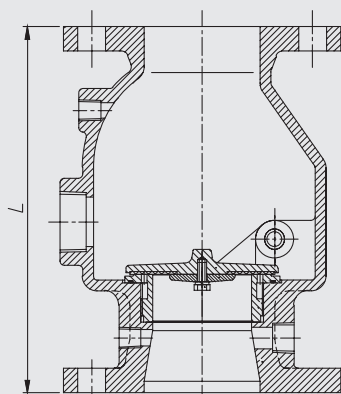

Dimensions (mm)			
Reference	FACV4	FACV6	FACV8
Size	DN100	DN150	DN200
L	270	340	432



- Indoor use for WET sprinkler systems only.
- Working pressure:
 - FM: 20,7 barg/300 PSI
 - CE: 16 barg/230 PSI
- Resilient seating with EPDM-rubber against a bronze ring.
- Installation is allowed only in vertical pipes.
- Valve outer ends:
 - Flanged ends (FACV) according to EN 1092-2/PN16 standard.
- Meets the AWWA C 508 standard.
- Including a pre-assembled vertical trimset in accordance with FM/CE regulations
- The trimset includes a retard chamber and a pressure switch. A water gong motor is available in option. The trim-set features high quality parts and is build-up with union fittings for easy after-service.
- Anti-corrosion protection : high grade polyester powder coating, meets or exceed AWWA C550 standards.
- Check valve can be used outdoors, we do not recommend to use the standard trimset for outdoor application.

WET ALARM VALVE GROOVED WITH TRIM • GACV



DATASHEET

Profit wet alarm check valves are swing-type check valves that allow water flow in one direction. They automatically actuate an electric or hydraulic alarm when one or more sprinkler-heads are activated. Type GACV has a grooved in-and outlet. The valves are designed to be used in WET fire protection.

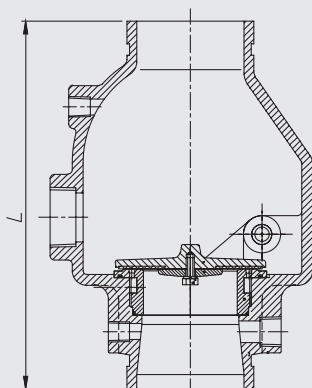

Dimensions (mm)			
Reference	GACV4	GACV6	GACV8
Size	DN100	DN150	DN200
L	270	340	432



- Indoor use for WET sprinkler systems only.
- Working pressure:
 - FM: 20,7 barg/300 PSI
 - CE: 16 barg/230 PSI
- Resilient seating with EPDM-rubber against a bronze ring.
- Installation is allowed only in vertical pipes.
- Valve outer ends:
 - Grooved ends (GACV): grooves according AWWA.
- Meets the AWWA C 508 standard.
- Including a pre-assembled vertical trimset in accordance with FM/CE regulations
- The trimset includes a retard chamber and a pressure switch. A water gong motor is available in option. The trim-set features high quality parts and is build-up with union fittings for easy after-service.
- Anti-corrosion protection : high grade polyester powder coating, meets or exceed AWWA C550 standards.
- Check valve can be used outdoors, we do not recommend to use the standard trimset for outdoor application.

MOTOR GONG FOR ALARM VALVES • WMG

Profit water motor gong type WMG is a hydraulically automated sound device actuated by water flow. The gong is intended to use on alarm check valves in fire protection sprinkler systems. Brand: WEFLO.



DATASHEET

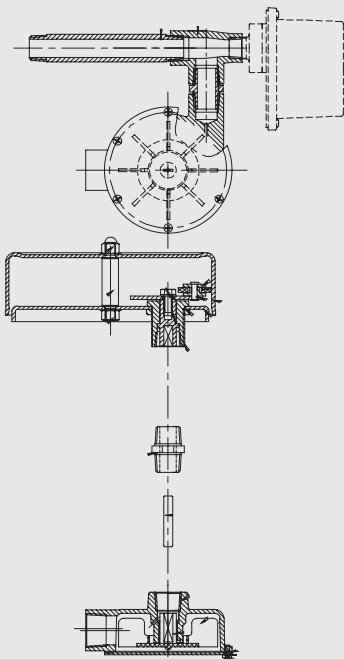
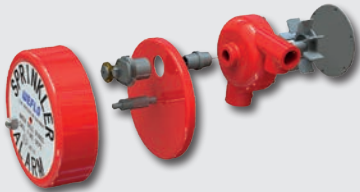

Reference

WMG



- in- and outdoor use.
- Self contained, line pressure operated.
- Quick response 90dB sound level.
- Wheaterproof anti-corrosion protected.
- Connections:
 - Inlet 3/4 npt
 - Outlet drain: 1" npt

PROFLEX



FLEXIBLE HOSE • UNBRAIDED • PFUH

Certified
CNPB

DATASHEET

The Proflex flexible sprinkler connections provide a simple and fast solution for use in automatic sprinkler systems.
The fastest solution to connect your sprinklers heads.

SET COMPONENTS

	1	Flexible sprinkler hose	
	2	Nipple 1"	
	3	Sprinkler reducer NPT outlet	
	4	Center bracket	
	5	Short/long bar fixing clamps (x2)	
	6	Bar	

SETS	
Reference	Components
PFUH700M34BSPT12SET*	Proflex 700 mm unbraided with Proflex standard reducer NPT M34 size 1/2"
PFUH700M34BSPT34SET*	Proflex 700 mm unbraided with Proflex standard reducer NPT M34 size 3/4"
PFUH1000M34BSPT12SET	Proflex 1000 mm unbraided with Proflex standard reducer NPT M34 size 1/2"
PFUH1000M34BSPT34SET*	Proflex 1000 mm unbraided with Proflex standard reducer NPT M34 size 3/4"
PFUH1200M34BSPT12SET	Proflex 1200 mm unbraided with Proflex standard reducer NPT M34 size 1/2"
PFUH1200M34BSPT34SET*	Proflex 1200 mm unbraided with Proflex standard reducer NPT M34 size 3/4"
PFUH1500M34BSPT12SET	Proflex 1500 mm unbraided with Proflex standard reducer NPT M34 size 1/2"
PFUH1500M34BSPT34SET*	Proflex 1500 mm unbraided with Proflex standard reducer NPT M34 size 3/4"
PFUH1800M34BSPT12SET*	Proflex 1800 mm unbraided with Proflex standard reducer NPT M34 size 1/2"
PFUH1800M34BSPT34SET*	Proflex 1800 mm unbraided with Proflex standard reducer NPT M34 size 3/4"

* ONLY AVAILABLE IN CONTAINER DIRECTLY FROM FACTORY.

1 SET INCLUDES:

- 1x flexible hose: stainless steel AISI 304, 1.4301.
Outer braid: stainless steel AISI 304, 1.4301.
- 1x inlet nipple: plated carbon steel.
- 1x outlet reducer: plated carbon steel.
- 1x center bracket: plated carbon steel.
- 2x short fixing clamp: plated carbon steel.
- 1x 700mm bar: plated carbon steel, square tube.



FLEXIBLE HOSE • BRAIDED • PFBH



DATASHEET

The Proflex flexible sprinkler connections provide a simple and fast solution for use in automatic sprinkler systems.
The fastest solution to connect your sprinklers heads.

SET COMPONENTS

	1 Flexible sprinkler hose	
	2 Nipple 1"	
	3 Sprinkler reducer NPT outlet	
	4 Center bracket	
	5 Short/long bar fixing clamps (x2)	
	6 Bar	

SETS	
Reference	Components
PFBH700M34BSPT12SET*	Proflex 700 mm braided hose with Proflex standard reducer NPT M34 size 1/2"
PFBH700M34BSPT34SET*	Proflex 700 mm braided hose with Proflex standard reducer NPT M34 size 3/4"
PFBH1000M34BSPT12SET	Proflex 1000 mm braided hose with Proflex standard reducer NPT M34 size 1/2"
PFBH1000M34BSPT34SET*	Proflex 1000 mm braided hose with Proflex standard reducer NPT M34 size 3/4"
PFBH1200M34BSPT12SET	Proflex 1200 mm braided with Proflex standard reducer NPT M34 size 1/2"
PFBH1200M34BSPT34SET*	Proflex 1200 mm braided with Proflex standard reducer NPT M34 size 3/4"
PFBH1500M34BSPT12SET	Proflex 1500 mm braided with Proflex standard reducer NPT M34 size 1/2"
PFBH1500M34BSPT34SET*	Proflex 1500 mm braided with Proflex standard reducer NPT M34 size 3/4"
PFBH1800M34BSPT12SET*	Proflex 1800 mm braided with Proflex standard reducer NPT M34 size 1/2"
PFBH1800M34BSPT34SET*	Proflex 1800 mm braided with Proflex standard reducer NPT M34 size 3/4"

* ONLY AVAILABLE IN CONTAINER DIRECTLY FROM FACTORY.

1 SET INCLUDES:

- 1x flexible hose: stainless steel AISI 304, 1.4301.
Outer braid: stainless steel AISI 304, 1.4301.
- 1x inlet nipple: plated carbon steel.
- 1x outlet reducer: plated carbon steel.
- 1x center bracket: plated carbon steel.
- 2x short fixing clamp: plated carbon steel.
- 1x 700mm bar: plated carbon steel, square tube.



FLEXIBLE HOSE • PARTS



DATASHEET

The Proflex flexible sprinkler connections provide a simple and fast solution for use in automatic sprinkler systems.

PROFLEX STANDARD 3/4" REDUCER

Reference	Description
PF-STR-NPT-3/4M34P	Proflex standard reducer NPT M34 3/4



- With this option it's possible to change a 1/2" Proflex outlet into a 3/4" outlet.

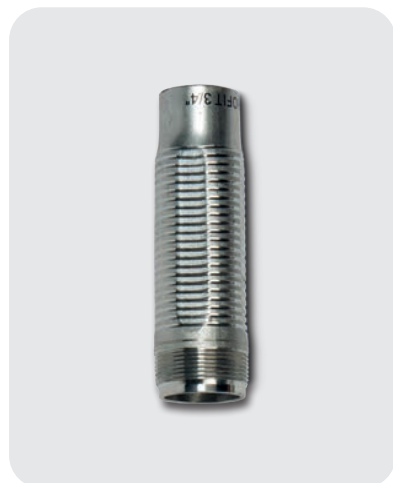

PROFLEX ELBOW REDUCER

Reference	Description
PF-ELR-110-1/2	Proflex elbow reducer 110 M34 NPT 1/2
PF-ELR-155-1/2	Proflex elbow reducer 155 M34 NPT 1/2
PF-ELR-110-3/4	Proflex elbow reducer 110 M34 NPT 3/4
PF-ELR-155-3/4	Proflex elbow reducer 155 M34 NPT 3/4



- Elbow reducers are being used in low profile installations (limited space between ceiling and sprinkler tubes).



PROFLEX LONG CLAMP

Reference	Description
PF-STC-LP	Proflex long clamp 105mm



- Suitable for concealed sprinklers.





COUPLINGS & FITTINGS

ANGLE-PAD RIGID COUPLING • GKA



DATASHEET

Angle-pad couplings GKA provide a full rigid connection of grooved pipes and/or grooved fittings. The coupling has been designed to achieve angular and axial stiffness by firmly clamping in the groove base. Small internal dents give an anti-torsional resistance and the angled bolt-pads guarantee rigidity under all pipe and groove conditions.

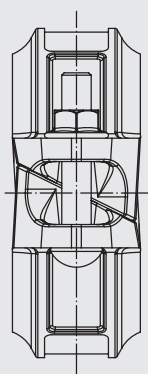
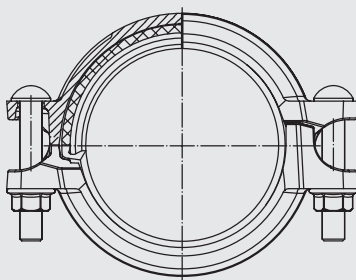

Reference		Nominal size		Pipe Ø O.D.
Red	Galva	NPS inch	DN mm	mm
GKAR1	GKAG1	1	25	33,7
GKAR11/4	GKAG11/4	1¼	32	42,4
GKAR11/2	GKAG11/2	1½	40	48,3
GKAR2	GKAG2	2	50	60,3
GKAR73	GKAG73	2½	65	73,0
GKAR21/2	GKAG21/2	2½	65	76,1
GKAR3	GKAG3	3	80	88,9
GKAR4	GKAG4	4	100	114,3
GKAR5	GKAG5	5	125	139,7
GKAR141	GKAG141	5	125	141,3
GKAR165	GKAG165	6	150	165,1
GKAR6	GKAG6	6	150	168,3
GKAR8	GKAG8	8	200	219,1
GKAR10	GKAG10	10	250	273,0
GKAR12	GKAG12	12	300	323,9
GKAR14*	GKAG14*	14	350	356,0
GKAR16*	GKAG16*	16	400	406,4

* ONLY AVAILABLE IN CONTAINER DIRECTLY FROM FACTORY.

The following sizes are also available on request, in container: 73mm / 141,3mm / 165,1mm.

MATERIAL

- **Housing:** ductile iron conform to ASTM A536 GR 65-45-12.
- **Coating:**
 - Hot dip galvanized.
 - Red paint coating RAL 3000, EPD Epoxy coating.
- **Gasket:** EPDM-rubber; optional: NBR-rubber.
- **Bolts & nuts:** Carbon steel grade 8.8, zinc electroplated.



Ultimate rigidity, minimum axial tolerance.

GROOVED RIGID COUPLING • GKS



DATASHEET

Rigid couplings GKS provide a rigid connection of grooved pipes and/or grooved fittings. The coupling has been designed to achieve angular and axial stiffness by firmly clamping in the groove base. Small internal dents give an anti-torsional resistance and the standard spigot and socket design assures an easy installation and full gasket protection.

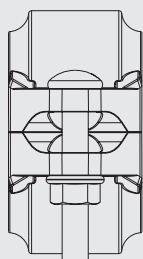
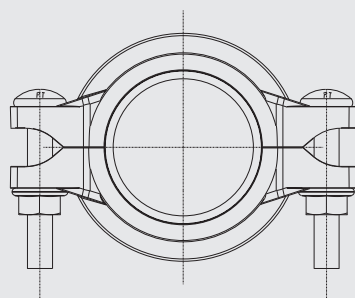

Reference			Nominal size		Pipe Ø O.D.
Red	Galva	White	NPS inch	DN mm	mm
GKSR1	GKSG1	GKSW1	1	25	33,7
GKSR1¼	GKSG1¼	GKSW1¼	1¼	32	42,4
GKSR1½	GKSG1½	GKSW1½	1½	40	48,3
GKSR2	GKSG2	GKSW2	2	50	60,3
GKSR2½	GKSG2½	GKSW2½	2½	65	76,1
GKSR3	GKSG3	GKSW3	3	80	88,9
GKSR4	GKSG4	GKSW4	4	100	114,3
GKSR5	GKSG5	GKSW5	5	125	139,7
GKSR6	GKSG6	GKSW6	6	150	168,3
GKSR8	GKSG8	GKSW8	8	200	219,1
GKSR10	GKSG10	GKSW10	10	250	273,0
GKSR12	GKSG12*	not available	12	300	323,9

* ONLY AVAILABLE IN CONTAINER DIRECTLY FROM FACTORY.

The following sizes are also available on request, in container:
73mm / 141,3mm / 165,1mm / 216mm / 318mm.

MATERIAL

- **Housing:** ductile iron conform to ASTM A536 GR 65-45-12.
- **Coating:**
 - Hot dip galvanized.
 - Red paint coating RAL 3000, EPD Epoxy coating.
- **Gasket:** EPDM-rubber; optional: NBR-rubber.
- **Bolts & nuts:** Carbon steel grade 8.8, zinc electroplated.



Economic solution.



GROOVED FLEXIBLE COUPLING • GKF



DATASHEET

Flexible couplings GKF are designed to allow axial displacement, rotation and some angular movement. The coupling can accommodate angular misalignments up to a few degrees. It can also accommodate parallel misalignment and/or thermal deformation when using two couplings with an intermediate pipe.

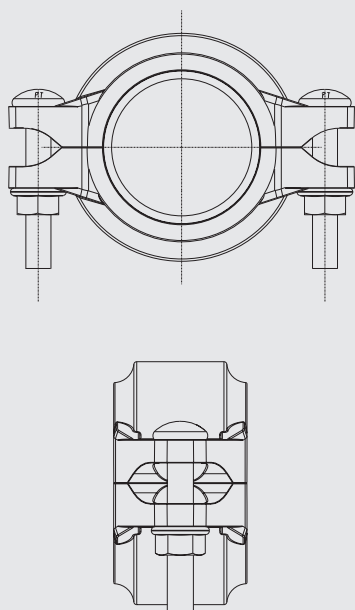

Reference		Nominal size		Pipe Ø O.D.
Red	Galva	NPS inch	DN mm	mm
GKFR1	GKFG1	1	25	33,7
GKFR1¼	GKFG1¼	1¼	32	42,4
GKFR1½	GKFG1½	1½	40	48,3
GKFR2	GKFG2	2	50	60,3
GKFR2½	GKFG2½	2½	65	76,1
GKFR3	GKFG3	3	80	88,9
GKFR4	GKFG4	4	100	114,3
GKFR5	GKFG5	5	125	139,7
GKFR6	GKFG6	6	150	168,3
GKFR8	GKFG8	8	200	219,1
GKFR10	GKFG10	10	250	273,0
GKFR12	GKFG12*	12	300	323,9
GKFR18*	GKFG18*	18	450	457,0
GKFR20*	GKFG20*	20	500	508,0
GKFR22*	GKFG22*	22	550	558,8
GKFR24*	GKFG24*	24	600	609,6

* ONLY AVAILABLE IN CONTAINER DIRECTLY FROM FACTORY.

The following sizes are also available on request, in container:
73mm / 141,3mm / 165,1mm / 216mm / 267mm / 318mm / 480mm.

MATERIAL

- **Housing:** ductile iron conform to ASTM A536 GR 65-45-12.
- **Coating:**
 - Hot dip galvanized.
 - Red paint coating RAL 3000, EPD Epoxy coating.
- **Gasket:** EPDM-rubber; optional: NBR-rubber.
- **Bolts & nuts:** Carbon steel grade 8.8, zinc electroplated.



Absorb misalignments, compensate movements.



GROOVED RIGID COUPLING ANGLE-PAD • GKSH



DATASHEET

Angle-pad couplings GKSH provide a full rigid connection of grooved pipes and/or grooved fittings. The coupling has been designed to achieve angular and axial stiffness by firmly clamping in the groove base. Small internal dents give an anti-torsional resistance and the angled bolt-pads guarantee rigidity under all pipe and groove conditions.

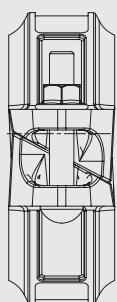
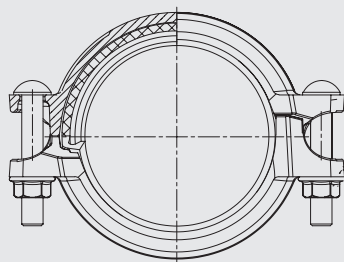

Reference		Nominal size		Pipe Ø O.D.
Red	Galva	NPS inch	DN mm	mm
GKSHR2	GKSHG2	2	50	60,3
GKSHR2½	GKSHG2½	2½	65	76,1
GKSHR3	GKSHG3	3	80	88,9
GKSHR4	GKSHG4	4	100	114,3
GKSHR5	GKSHG5	5	125	139,7
GKSHR6	GKSHG6	6	150	168,3
GKSHR8	GKSHG8	8	200	219,1

The following sizes are also available on request, in container directly from factory:
73mm / 141,3mm / 165,1mm.

MATERIAL

- **Housing:** ductile iron conform to ASTM A536 GR 65-45-12.
- **Coating:**
 - Hot dip galvanized.
 - Red paint coating RAL 3000, EPD Epoxy coating.
- **Gasket:** EPDM-rubber; optional: NBR-rubber.
- **Bolts & nuts:** Carbon steel grade 8.8, zinc electroplated.



Heavy coupling, suitable for higher working pressure.





REDUCING COUPLING WITH STEEL RING • GRKF



DATASHEET

This coupling GRKF is a flexible coupling that allows for direct size reduction on a piping run and eliminates the need for a concentric reducer + couplings. The gasket has special design that allows both for horizontal and vertical installation.

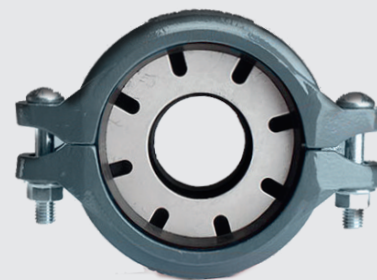
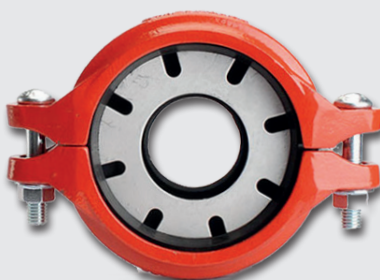
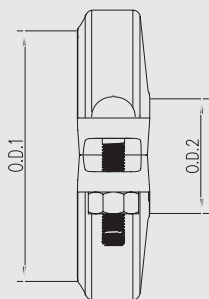
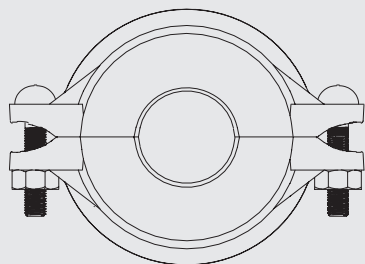

Reference		Nominal size		Pipe Ø O.D. - T
Red	Galva	NPS inch	DN mm	mm - inch
GRKFR1½-1¼	GRKFG1½-1¼	1½ - 1¼	40-32	48,3 - 1¼
GRKFR2-1½	GRKFG2-1½	2 - 1½	50-40	60,3 - 1½
GRKFR2½-1¼	GRKFG2½-1¼	2½ - 1¼	65-32	73,0 - 1¼
GRKFR2½-1½	GRKFG2½-1½	2½ - 1½	65-40	73,0 - 1½
GRKFR2½-2	GRKFG2½-2	2½ - 2	65-50	73,0 - 2
GRKFR3-1	GRKFG3-1	3 - 1	80-25	89,9 - 1
GRKFR3-1¼	GRKFG3-1¼	3 - 1¼	80-32	88,9 - 1¼
GRKFR3-1½	GRKFG3-1½	3 - 1½	80-40	88,9 - 1½
GRKFR3-2	GRKFG3-2	3 - 2	80-50	88,9 - 2
GRKFR3-2½	GRKFG3-2½	3 - 2½	80-65	88,9 - 2½
GRKFR4-2	GRKFG4-2	4 - 2	100-50	114,3 - 2
GRKFR4-2½	GRKFG4-2½	4 - 2½	100-65	114,3 - 2½
GRKFR4-3	GRKFG4-3	4 - 3	100-80	114,3 - 3
GRKFR6-3	GRKFG6-3	6 - 3	150-80	168,3 - 3
GRKFR6-4	GRKFG6-4	6 - 4	150-100	168,3 - 4
GRKFR8-4	GRKFG8-4	8 - 4	100 100	219,1 - 4
GRKFR8-6	GRKFG8-6	8 - 6	200-150	219,1 - 6

The following sizes are also available on request, in container directly from factory:
73mm / 141,3mm / 165,1mm.

MATERIAL

- **Housing:** ductile iron conform to ASTM A536 GR 65-45-12.
- **Coating:**
 - Hot dip galvanized.
 - Red paint coating RAL 3000, EPD Epoxy coating.
- **Gasket:** EPDM-rubber; optional: NBR-rubber.
- **Bolts & nuts:** Carbon steel grade 8.8, zinc electroplated.



Space saving solution, reducing one fitting and one coupling.

U-BOLT SPRINKLER TEE • GST



DATASHEET

Sprinkler tees GST are designed for direct connection of sprinkler heads. **With threaded BSPT outlet.**

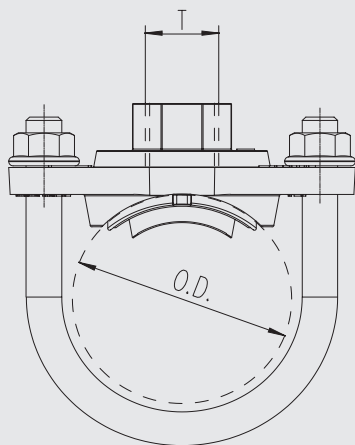

Reference		Nominal size Run - reducing outlet		Pipe Ø O.D. - T
Red	Galva	NPS inch	DN mm	mm - inch
GSTR1-1/2	GST1-1/2	1-1/2	25-15	33,7 - 1/2
GSTR1-3/4*	GST1-3/4*	1-3/4	25-20	33,7 - 3/4
GSTR1 1/4-1/2	GST1 1/4-1/2	1 1/4-1/2	32-15	42,4 - 1/2
GSTR1 1/4-3/4	GST1 1/4-3/4	1 1/4-3/4	32-20	42,4 - 3/4
GSTR1 1/4-1	GST1 1/4-1	1 1/4-1	32-25	42,4 - 1
GSTR1 1/2-1/2	GST1 1/2-1/2	1 1/2-1/2	40-15	48,3 - 1/2
GSTR1 1/2-3/4	GST1 1/2-3/4	1 1/2-3/4	40-20	48,3 - 3/4
GSTR1 1/2-1	GST1 1/2-1	1 1/2-1	40-25	48,3 - 1
GSTR2-1/2	GST2-1/2	2-1/2	50-15	60,3 - 1/2
GSTR2-3/4	GST2-3/4	2-3/4	50-20	60,3 - 3/4
GSTR2-1	GST2-1	2-1	50-25	60,3 - 1
GSTR2 1/2-1/2*	GST2 1/2-1/2*	2 1/2-1/2	65-15	76,1 - 1/2
GSTR2 1/2-3/4*	GST2 1/2-3/4*	2 1/2-3/4	65-20	76,1 - 3/4
GSTR2 1/2-1*	GST2 1/2-1*	2 1/2-1	65-25	76,1 - 1
GSTR3-1*	GST3-1*	3-1	80-25	88,9 - 1

* ONLY AVAILABLE IN CONTAINER DIRECTLY FROM FACTORY.

The following sizes are also available on request, in container: 73mm.

MATERIAL

- **Housing:** ductile iron conform to ASTM A536 GR 65-45-12.
- **Coating:**
 - Hot dip galvanized.
 - Red paint coating RAL 3000, EPD Epoxy coating.
- **Gasket:** EPDM-rubber.
- **Bolts & nuts:** Carbon steel grade 8.8, zinc electroplated.



Economic sprinkler tee design, easy assembly.



FULL CASTING SPRINKLER TEE • GSTFC



DATASHEET

Sprinkler tees GSTFC are designed for direct connections of sprinkler heads. Thanks to the pipe-shaped casting collar and outlet shape, this design is easy to install. **With threaded BSPT outlet.**

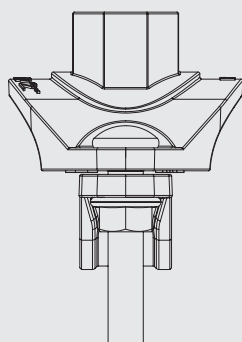
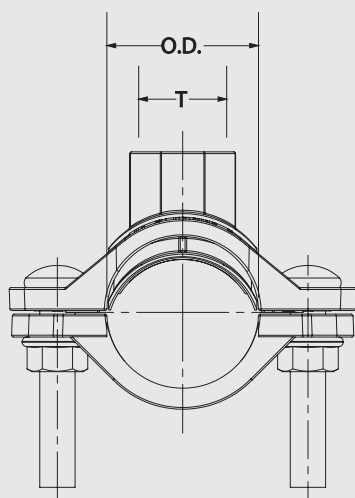
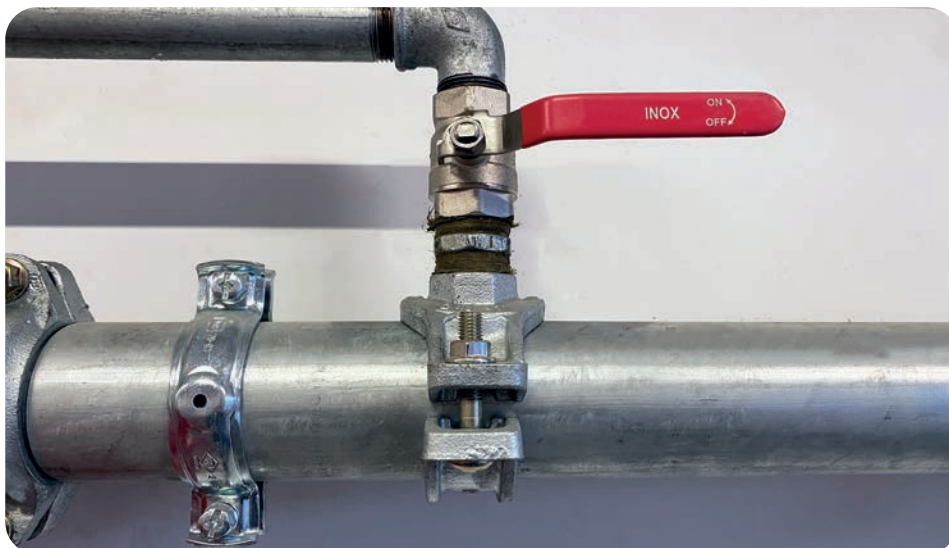

Reference		Nominal size Run - reducing size		Pipe Ø O.D. - T
Red	Galva	NPS inch	DN mm	mm - inch
GSTFCR1-½*	GSTFCG1-½*	1-½	25-15	33,7 - ½
GSTFCR1¼-½	GSTFCG1¼-½	1¼-½	32-15	42,4 - ½
GSTFCR1¼-¾	GSTFCG1¼-¾	1¼-¾	32-20	42,4 - ¾
GSTFCR1¼-1	GSTFCG1¼-1	1¼-1	32-25	42,4 - 1
GSTFCR1½-½	GSTFCG1½-½	1½-½	40-15	48,3 - ½
GSTFCR1½-¾	GSTFCG1½-¾	1½-¾	40-20	48,3 - ¾
GSTFCR1½-1	GSTFCG1½-1	1½-1	40-25	48,3 - 1
GSTFCR2-½	GSTFCG2-½	2-½	50-15	60,3 - ½
GSTFCR2-¾	GSTFCG2-¾	2-¾	50-20	60,3 - ¾
GSTFCR2-1	GSTFCG2-1	2-1	50-25	60,3 - 1
GSTFCR2½-½	GSTFCG2½-½	2½-½	65-15	76,1 - ½
GSTFCR2½-¾	GSTFCG2½-¾	2½-¾	65-20	76,1 - ¾
GSTFCR2½-1	GSTFCG2½-1	2½-1	65-25	76,1 - 1

* ONLY AVAILABLE IN CONTAINER DIRECTLY FROM FACTORY.

The following sizes are also available on request, in container: 73mm.

MATERIAL

- **Housing:** ductile iron conform to ASTM A536 GR 65-45-12.
- **Coating:**
 - Hot dip galvanized.
 - Red paint coating RAL 3000, EPD Epoxy coating.
- **Gasket:** EPDM-rubber.
- **Bolts & nuts:** Carbon steel grade 8.8, zinc electroplated.



Solid sprinkler tee design.

MECHANICAL TEE GROOVED OUTLET • GMG



Mechanical tees GMG with grooved outlet can be used for any tee connection where a grooved outlet is needed. They may be converted into a cross when necessary.

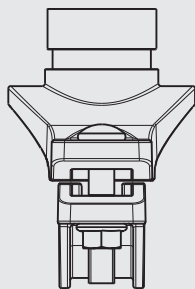
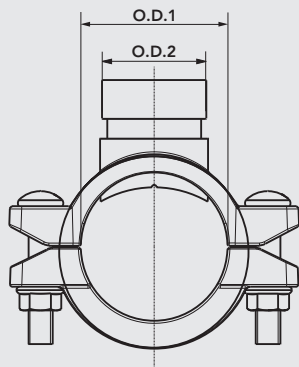

Reference		Nominal size Run - reducing outlet		Pipe Ø O.D.1 - O.D.2
Red	Galva	NPS inch	DN mm	O.D.1 - O.D.2 mm
GMGR2-1*	GMGR2-1*	2 - 1	50-25	60,3 - 33,7
GMGR2-1¼	GMGG2-1¼	2 - 1¼	50-32	60,3 - 42,4
GMGR2-1½	GMGG2-1½	2 - 1½	50-40	60,3 - 48,3
GMGR2½-1¼	GMGG2½-1¼	2½ - 1¼	65-32	76,1 - 42,4
GMGR2½-1½	GMGG2½-1½	2½ - 1½	65-40	76,1 - 48,3
GMGR2½-2	GMGR2½-2	2½ - 2	65-50	76,1 - 60,3
GMGR3-1¼	GMGG3-1¼	3 - 1¼	80-32	88,9 - 42,4
GMGR3-1½	GMGG3-1½	3 - 1½	80-40	88,9 - 48,3
GMGR3-2	GMGG3-2	3 - 2	80-50	88,9 - 60,3
GMGR4-1*	GMGR4-1*	4 - 1	100-25	114,3 - 33,7
GMGR4-1¼	GMGG4-¼	4 - 1¼	100-32	114,3 - 42,4
GMGR4-1½	GMGG4-1½	4 - 1½	100-40	114,3 - 48,3
GMGR4-2	GMGG4-2	4 - 2	100-50	114,3 - 60,3
GMGR4-2½	GMGG4-2½	4 - 2½	100-65	114,3 - 76,1
GMGR4-3	GMGG4-3	4 - 3	100-80	114,3 - 88,9
GMGR5-1½*	GMGR5-1½*	5 - 1½	125-40	139,7 - 48,3
GMGR5-2	GMGG5-2	5 - 2	125-50	139,7 - 60,3
GMGR5-2½	GMGG5-2½	5 - 2½	125-65	139,7 - 76,1
GMGR5-3*	GMGR5-3*	5 - 3	125-80	139,7 - 88,9
GMGR6-1¼	GMGG6-1¼	6 - 1¼	150-32	168,3 - 42,4
GMGR6-1½	GMGG6-1½	6 - 1½	150-40	168,3 - 48,3
GMGR6-2	GMGG6-2	6 - 2	150-50	168,3 - 60,3
GMGR6-2½	GMGG6-2½	6 - 2½	150-65	168,3 - 76,1
GMGR6-3	GMGG6-3	6 - 3	150-80	168,3 - 88,9

MECHANICAL TEE GROOVED OUTLET • GMG



DATASHEET

Mechanical tees GMG with grooved outlet can be used for any tee connection where a grooved outlet is needed. They may be converted into a cross when necessary.

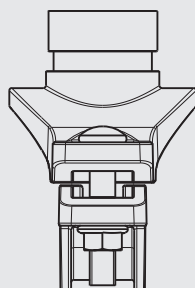
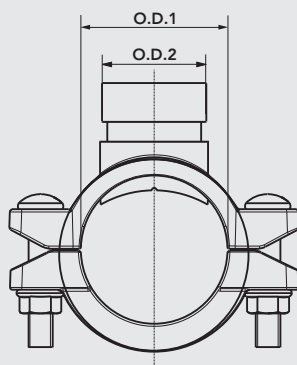

Reference		Nominal size Run - reducing outlet		Pipe Ø O.D. - T
Red	Galva	NPS inch	DN mm	O.D.1 - O.D.2 mm
GMGR6-4	GMGG6-4	6 - 4	150-100	168,3 - 114,3
GMGR8-2*	GMGR8-2*	8 - 2	200-50	219,1 - 60,3
GMGR8-2½	GMGG8-2½	8 - 2½	200-65	219,1 - 76,1
GMGR8-3	GMGG8-3	8 - 3	200-80	219,1 - 88,9
GMGR8-4*	GMGR8-4*	8 - 4	200-100	219,1 - 114,3

* ONLY AVAILABLE IN CONTAINER DIRECTLY FROM FACTORY.

The following sizes are also available on request, in container:
73mm / 114,3mm / 139,7mm / 141,3mm / 165,1mm / 168,3mm / 219,1mm.

MATERIAL

- **Housing:** ductile iron conform to ASTM A536 GR 65-45-12.
- **Coating:**
 - Hot dip galvanized.
 - Red paint coating RAL 3000, EPD Epoxy coating.
- **Gasket:** EPDM-rubber; optional: NBR-rubber.
- **Bolts & nuts:** Carbon steel grade 8.8, zinc electroplated.



Solid threaded branch outlet design.

MECHANICAL TEE • GMD



Threaded mechanical tees GMD may be used for any tee connection where a threaded outlet is needed. Some sizes may be converted into a cross when necessary. **With threaded BSPT outlet.**

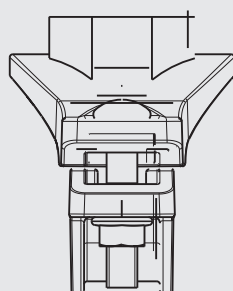
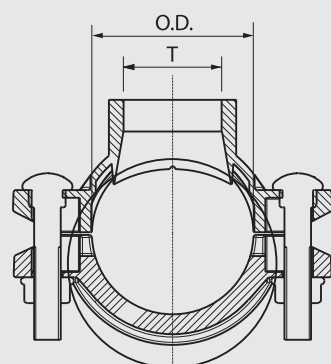

Reference		Nominal size Run - reducing outlet		Pipe Ø O.D. - T
Red	Galva	NPS inch	DN mm	mm - inch
GMDR2-1¼	GMDG2-1¼	2-1¼	50-32	60,3 - 1¼
GMDR2-1½	GMDG2-1½	2-1½	50-40	60,3 - 1½
GMDR2½-1¼	GMDG2½-1¼	2½-1¼	65-32	76,1 - 1¼
GMDR2½-1½	GMDG2½-1½	2½-1½	65-40	76,1 - 1½
GMDR2½-2*	GMDG2½-2*	2½-2	65-50	76,1 - 2
GMDR3-½*	GMDG3-½*	3-½	80-15	88,9 - ½
GMDR3-¾*	GMDG3-¾*	3-¾	80-20	88,9 - ¾
GMDR3-1	GMDG3-1	3-1	80-25	88,9 - 1
GMDR3-1¼	GMDG3-1¼	3-1¼	80-32	88,9 - 1¼
GMDR3-1½	GMDG3-1½	3-1½	80-40	88,9 - 1½
GMDR3-2	GMDG3-2	3-2	80-50	88,9 - 2
GMDR3-2½*	GMDG3-2½*	3-2½	80-65	88,9 - 2½
GMDR4-½*	GMDG4-½*	4-½	100-15	114,3 - ½
GMDR4-¾*	GMDG4-¾*	4-¾	100-20	114,3 - ¾
GMDR4-1*	GMDG4-1*	4-1	100-25	114,3 - 1
GMDR4-1¼	GMDG4-1¼	4-1¼	100-32	114,3 - 1¼
GMDR4-1½	GMDG4-1½	4-1½	100-40	114,3 - 1½
GMDR4-2	GMDG4-2	4-2	100-50	114,3 - 2
GMDR4-2½	GMDG4-2½	4-2½	100-65	114,3 - 2½
GMDR4-3*	GMDG4-3*	4-3	100-80	114,3 - 3
GMDR5-1*	GMDG5-1*	5-1	125-25	139,7 - 1
GMDR5-1¼*	GMDG5-1¼*	5-1¼	125-32	139,7 - 1¼
GMDR5-1½*	GMDG5-1½*	5-1½	125-40	139,7 - 1½
GMDR5-2*	GMDG5-2*	5-2	125-50	139,7 - 2
GMDR5-2½*	GMDG5-2½*	5-2½	125-65	139,7 - 2½
GMDR5-3*	GMDG5-3*	5-3	125-80	139,7 - 3
GMDR6-1*	GMDG6-1*	6-1	150-25	168,3 - 1
GMDR6-1¼	GMDG6-1¼	6-1¼	150-32	168,3 - 1¼
GMDR6-1½	GMDG6-1½	6-1½	150-40	168,3 - 1½

MECHANICAL TEE • GMD



DATASHEET

Threaded mechanical tees GMD may be used for any tee connection where a threaded outlet is needed. Some sizes may be converted into a cross when necessary. **With threaded BSPT outlet.**



Reference		Nominal size Run - reducing outlet		Pipe Ø O.D. - T
Red	Galva	NPS inch	DN mm	mm - inch
GMDR6-2	GMDG6-2	6-2	150-50	168,3 - 2
GMDR6-2½	GMDG6-2½	6-2½	150-65	168,3 - 2½
GMDR6-3*	GMDG6-3*	6-3	150-80	168,3 - 3
GMDR6-4*	GMDG6-4*	6-4	150-100	168,3 - 4
GMDR8-1*	GMDG8-1*	8-1	200-25	219,1 - 1
GMDR8-1¼*	GMDG8-1¼*	8-1¼	200-32	219,1 - 1¼
GMDR8-1½*	GMDG8-1½*	8-1½	200-40	219,1 - 1½
GMDR8-2*	GMDG8-2*	8-2	200-50	219,1 - 2
GMDR8-2½*	GMDG8-2½*	8-2½	200-65	219,1 - 2½
GMDR8-3*	GMDG8-3*	8-3	200-80	219,1 - 3
GMDR8-4*	GMDG8-4*	8-4	200-100	219,1 - 4

* ONLY AVAILABLE IN CONTAINER DIRECTLY FROM FACTORY.

The following sizes are also available on request, in container:
73mm / 114,3mm / 165,1mm / 168,3mm / 219,1mm.

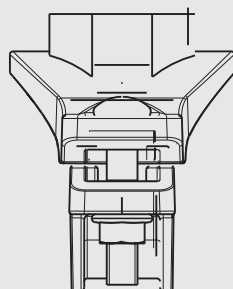
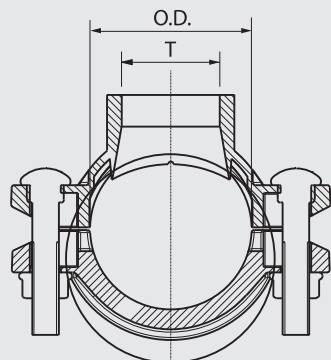

MATERIAL

- **Housing:** ductile iron conform to ASTM A536 GR 65-45-12.
- **Coating:**
 - Hot dip galvanized.
 - Red paint coating RAL 3000, EPD Epoxy coating.
- **Gasket:** EPDM-rubber; optional: NBR-rubber.
- **Bolts & nuts:** Carbon steel grade 8.8, zinc electroplated.



Solid grooved branch outlet design.



GROOVED ELBOW 11,25° • GB11



DATASHEET

Grooved elbows GB11 provide an economical and efficient method of changing direction in grooved piping systems.

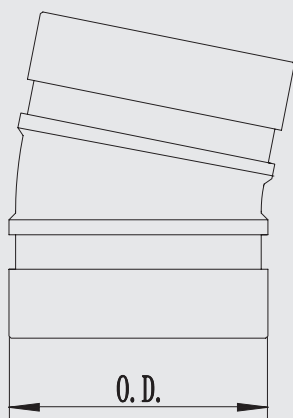

Reference		Nominal size		Pipe Ø O.D.
Red	Galva	NPS inch	DN mm	mm
GB11R1¼*	GB11G1¼*	1¼	32	42,4
GB11R1½*	GB11G1½*	1½	40	48,3
GB11R2	GB11G2*	2	50	60,3
GB11R2½	GB11G2½*	2½	65	76,1
GB11R3	GB11G3*	3	80	88,9
GB11R4	GB11G4*	4	100	114,3
GB11R5*	GB11G5*	5	125	139,7
GB11R6	GB11G6*	5	125	141,3
GB11R8	GB11G8*	6	150	168,3
GB11R	GB11G	8	200	219,1

* ONLY AVAILABLE IN CONTAINER DIRECTLY FROM FACTORY.

The following sizes are also available on request, in container: 73mm / 165,1mm.

MATERIAL

- **Housing:** ductile iron conform to ASTM A536 GR 65-45-12.
- **Coating:**
 - Hot dip galvanized.
 - Red paint coating RAL 3000, EPD Epoxy coating.



GROOVED ELBOW 22,50° • GB22



DATASHEET

Grooved elbows GB22 provide an economical and efficient method of changing direction in grooved piping systems.

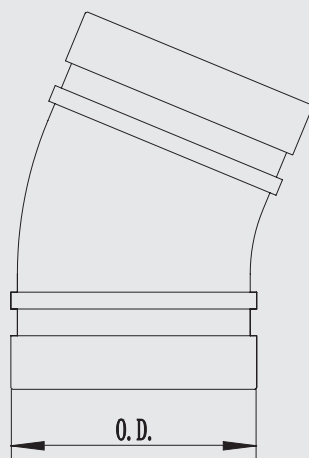

Reference		Nominal size		Pipe Ø O.D.
Red	Galva	NPS inch	DN mm	mm
GB22R1½*	GB22G1½*	1½	40	48,3
GB22R2	GB22G2*	2	50	60,3
GB22R2½	GB22G2½*	2½	65	76,1
GB22R3	GB22G3*	3	80	88,9
GB22R4	GB22G4*	4	100	114,3
GB22R5*	GB22G5*	5	125	139,7
GB22R6	GB22G6*	6	150	168,3
GB22R8	GB22G8*	8	200	219,1
GB22R10	GB22G10*	10	250	273,0

* ONLY AVAILABLE IN CONTAINER DIRECTLY FROM FACTORY.

The following sizes are also available on request, in container: 73mm / 165,1mm.

MATERIAL

- **Housing:** ductile iron conform to ASTM A536 GR 65-45-12.
- **Coating:**
 - Hot dip galvanized.
 - Red paint coating RAL 3000, EPD Epoxy coating.



GROOVED ELBOW 45° • GB45



DATASHEET

Grooved elbows GB45 provide an economical and efficient method of changing direction in grooved piping systems.

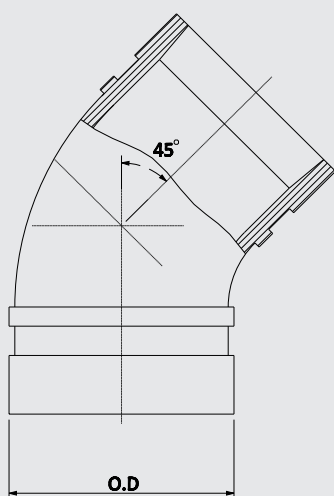

Reference		Nominal size		Pipe Ø O.D.
Red	Galva	NPS inch	DN mm	mm
GB45R1	GB45G1	1	25	33,7
GB45R1¼	GB45G1¼	1¼	32	42,4
GB45R1½	GB45G1½	1½	40	48,3
GB45R2	GB45G2	2	50	60,3
GB45R2½	GB45G2½	2½	65	76,1
GB45R3	GB45G3	3	80	88,9
GB45R4	GB45G4	4	100	114,3
GB45R5	GB45G5	5	125	139,7
GB45R6	GB45G6	6	150	168,3
GB45R8	GB45G8	8	200	219,1
GB45R10	GB45G10	10	250	273,0
GB45R12	GB45G12	12	300	323,9
GB45R14*	GB45G14*	14	350	356,0

* ONLY AVAILABLE IN CONTAINER DIRECTLY FROM FACTORY.

The following sizes are also available on request, in container: 141,3mm / 165,1mm.

MATERIAL

- **Housing:** ductile iron conform to ASTM A536 GR 65-45-12
- **Coating:**
 - Hot dip galvanized
 - Red paint coating RAL 3000, EPD Epoxy coating



GROOVED ELBOW 90° • GB90



DATASHEET

Grooved elbows GB90 provide an economical and efficient method of changing direction in grooved piping systems.

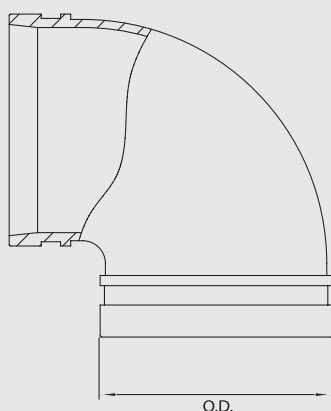

Reference			Nominal size		Pipe Ø O.D.
Red	Galva	White	NPS inch	DN mm	mm
GB90R1	GB90G1	GB90W1	1	25	33,7
GB90R1¼	GB90G1¼	GB90W1¼	1¼	32	42,4
GB90R1½	GB90G1½	GB90W1½	1½	40	48,3
GB90R2	GB90G2	GB90W2	2	50	60,3
GB90R2½	GB90G2½	GB90W2½	2½	65	76,1
GB90R3	GB90G3	GB90W3	3	80	88,9
GB90R4	GB90G4	GB90W4	4	100	114,3
GB90R5	GB90G5	GB90W5	5	125	139,7
GB90R6	GB90G6	GB90W6	6	150	168,3
GB90R8	GB90G8	GB90W8	8	200	219,1
GB90R10	GB90G10	GB90W10	10	250	273,0
GB90R12	GB90G12	GB90W12	12	300	323,9
GB90R14*	GB90G14*	GB90W14*	14	350	377,0

* ONLY AVAILABLE IN CONTAINER DIRECTLY FROM FACTORY.

The following sizes are also available on request, in container: 73mm / 141,3mm / 165,1mm.

MATERIAL

- **Housing:** ductile iron conform to ASTM A536 GR 65-45-12
- **Coating:**
 - Hot dip galvanized
 - Red paint coating RAL 3000, EPD Epoxy coating
 - White powder coating RAL 9010





GROOVED REDUCING ELBOW 90° • GBD90



DATASHEET

Grooved reducing elbows GBD90, with female threaded outlet, provide an economical and efficient method of changing direction in grooved piping systems.

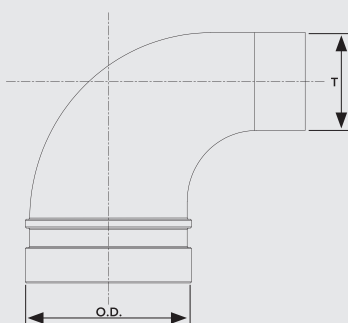

Reference		Nominal size		Pipe Ø O.D. - T
Red	Galva	NPS inch	DN mm	mm - inch
GBD90R1¼-½	GBD90G1¼-½	1¼ - ½	32-15	42,4 - ½
GBD90R1¼-¾	GBD90G1¼-¾	1¼ - ¾	32-20	42,4 - ¾
GBD90R1¼-1	GBD90G1¼-1	1¼ - 1	32-25	42,4 - 1
GBD90R1½-½	GBD90G1½-½	1½ - ½	40-15	48,3 - ½
GBD90R1½-¾	GBD90G1½-¾	1½ - ¾	40-20	48,3 - ¾
GBD90R1½-1	GBD90G1½-1	1½ - 1	40-25	48,3 - 1
GBD90R2-½	GBD90G2-½	2 - ½	50-15	60,3 - ½
GBD90R2-¾	GBD90G2-¾	2 - ¾	50-20	60,3 - ¾
GBD90R2-1	GBD90G2-1	2 - 1	50-25	60,3 - 1

MATERIAL

- **Housing:** ductile iron conform to ASTM A536 GR 65-45-12.
- **Coating:**
 - Hot dip galvanized.
 - Red paint coating RAL 3000, EPD Epoxy coating.
 - White powder coating RAL 9010.





DRAIN ELBOW 90° • 2601



DATASHEET

Grooved elbows 2601 with added 1" female threaded drain outlet, provide an economical and efficient method of changing direction in grooved piping systems.

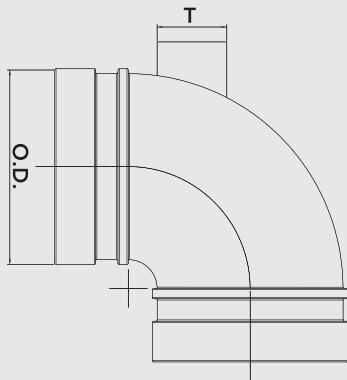

Reference		Nominal size		Pipe Ø O.D. - T
Red	Galva	NPS inch	DN mm	mm - inch
2601R2-1	2601G2-1	2	50	60,3 - 1
2601R2½-1	2601G2½-1	2½	65	76,1 - 1
2601R3-1	2601G3-1	3	80	88,9 - 1
2601R4-1	2601G4-1	4	100	114,3 - 1
2601R6-1	2601G6-1	6	150	165,1 - 1

MATERIAL

- **Housing:** ductile iron conform to ASTM A536 GR 65-45-12.
- **Coating:**
 - Hot dip galvanized.
 - Red paint coating RAL 3000, EPD Epoxy coating.



GROOVED EQUAL TEE • GT



DATASHEET

Grooved equal tees GT provide an economical and efficient method of changing direction and adding an outlet in piping systems.

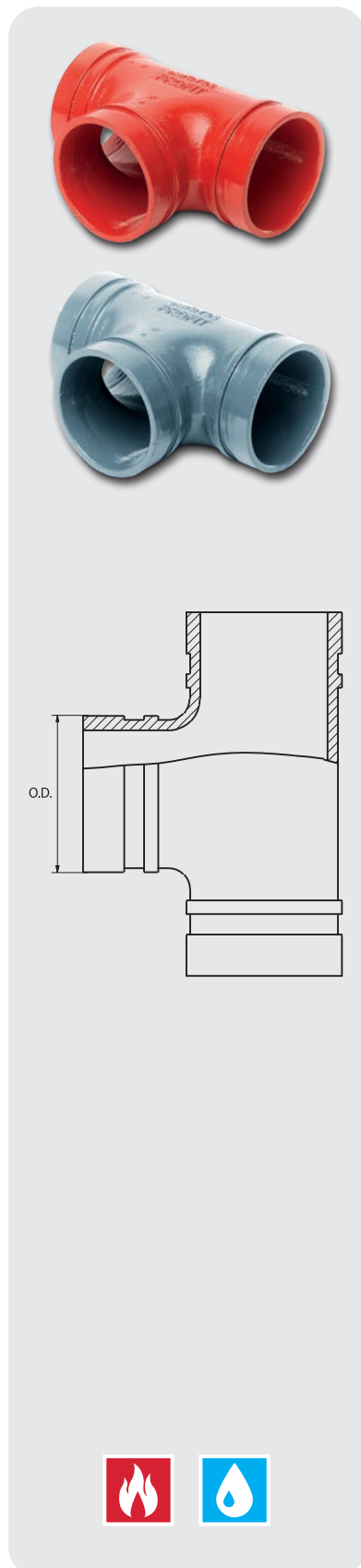

Reference		Nominal size		Pipe Ø O.D.
Red	Galva	NPS inch	DN mm	mm
GTR1	GTG1	1	25	33,7
GTR1¼	GTG1¼	1¼	32	42,4
GTR1½	GTG1½	1½	40	48,3
GTR2	GTG2	2	50	60,3
GTR2½	GTG2½	2½	65	76,1
GTR3	GTG3	3	80	88,9
GTR4	GTG4	4	100	114,3
GTR5	GTG5	5	125	139,7
GTR6	GTG6	6	150	168,3
GTR8	GTG8	8	200	219,1
GTR10	GTG10	10	250	273,0
GTR12	GTG12*	12	300	323,9
GTR14*	GTG14*	14	350	377,0

* ONLY AVAILABLE IN CONTAINER DIRECTLY FROM FACTORY.

The following sizes are also available on request, in container: 73mm / 141,3mm / 165,1mm.

MATERIAL

- **Housing:** ductile iron conform to ASTM A536 GR 65-45-12.
- **Coating:**
 - Hot dip galvanized.
 - Red paint coating RAL 3000, EPD Epoxy coating.





GROOVED EQUAL CROSS • GC



DATASHEET

Grooved equal crosses GC provide an economical and efficient fitting for a triple outlet change of direction in pipe systems. Installation only with approved Profit couplings.

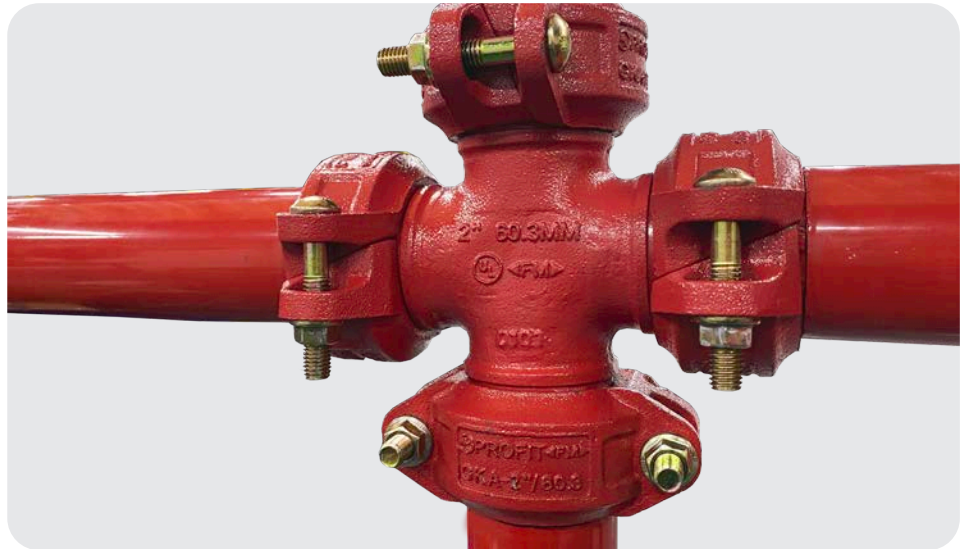
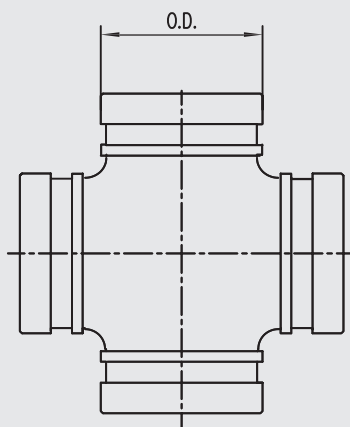

Reference		Nominal size		Pipe Ø O.D.
Red	Galva	NPS inch	DN mm	mm
GCR2	GCG2	2	50	60,3
GCR2½	GCG2½	2½	65	76,1
GCR3	GCG3	3	80	88,9
GCR4	GCG4	4	100	114,3
GCR5	GCG5	5	125	139,7
GCR6	GCG6	6	150	168,3
GCR8	GCG8	8	200	219,1
GCR10	GCG10	10	250	273,0
GCR12	GCG12	12	300	323,9

The following sizes are also available on request, in container directly from factory:
73mm / 141,3mm / 165,1mm.

MATERIAL

- **Housing:** ductile iron conform to ASTM A536 GR 65-45-12.
- **Coating:**
 - Hot dip galvanized.
 - Red paint coating RAL 3000, EPD Epoxy coating.



GROOVED CONCENTRIC REDUCER • GRC



Grooved concentric reducers GRC provide an economical and efficient method of reducing grooved piping systems.

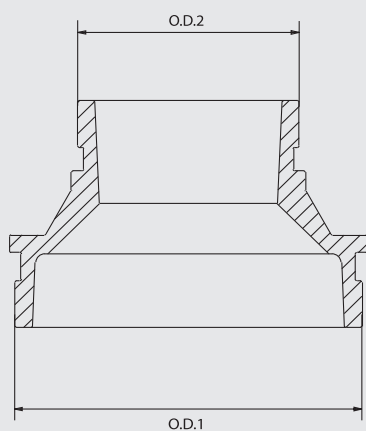

Reference		Nominal size		Pipe Ø O.D.
Red	Galva	NPS inch	DN mm	O.D.1 - O.D.2 mm
GRCR1¼-1*	GRCG1¼-1*	1¼ - 1	32-25	42,4 - 33,7
GRCR1½-1*	GRCG1½-1*	1½ - 1	40-25	48,3 - 33,7
GRCR1½-1¼	GRCG1½-1¼	1½ - 1¼	40-32	48,3 - 42,4
GRCR2-1*	GRCG2-1*	2 - 1	50-25	60,3 - 33,7
GRCR2-1¼*	GRCG2-1¼*	2 - 1¼	50-32	60,3 - 42,4
GRCR2-1½	GRCG2-1½	2 - 1½	50-40	60,3 - 48,3
GRCR2½-1*	GRCG2½-1*	2½ - 1	65-25	76,1 - 33,7
GRCR2½-1¼*	GRCG2½-1¼*	2½ - 1¼	65-32	76,1 - 42,4
GRCR2½-1½	GRCG2½-1½	2½ - 1½	65-40	76,1 - 48,3
GRCR2½-2	GRCG2½-2	2½ - 2	65-50	76,1 - 60,3
GRCR3-1¼*	GRCG3-1¼*	3 - 1¼	80-32	88,9 - 42,4
GRCR3-1½*	GRCG3-1½*	3 - 1½	80-40	88,9 - 48,3
GRCR3-2	GRCG3-2	3 - 2	80-50	88,9 - 60,3
GRCR3-2½	GRCG3-2½	3 - 2½	80-65	88,9 - 76,1
GRCR4-1¼*	GRCG4-1¼*	4 - 1¼	100-32	114,3 - 42,4
GRCR4-1½*	GRCG4-1½*	4 - 1½	100-40	114,3 - 48,3
GRCR4-2	GRCG4-2	4 - 2	100-50	114,3 - 60,3
GRCR4-2½	GRCG4-2½	4 - 2½	100-65	114,3 - 76,1
GRCR4-3	GRCG4-3	4 - 3	100-80	114,3 - 88,9
GRCR5-2	GRCG5-2	5 - 2	125-50	139,7 - 60,3
GRCR5-2½	GRCG5-2½	5 - 2½	125-65	139,7 - 76,1
GRCR5-3	GRCG5-3	5 - 3	125-80	139,7 - 88,9
GRCR5-4	GRCG5-4	5 - 4	125-100	139,7 - 114,3
GRCR6-2*	GRCG6-2*	6 - 2	150-50	168,3 - 60,3
GRCR6-2½*	GRCG6-2½*	6 - 2½	150-65	168,3 - 76,1

GROOVED CONCENTRIC REDUCER • GRC



DATASHEET

Grooved concentric reducers GRC provide an economical and efficient method of reducing grooved piping systems.

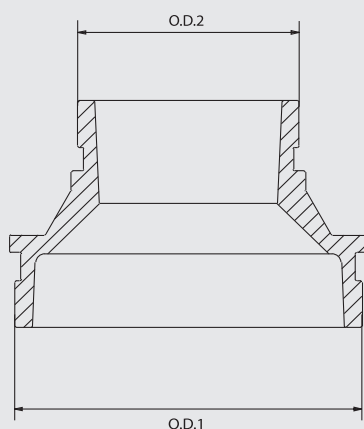

Reference		Nominal size		Pipe Ø O.D.
Red	Galva	NPS inch	DN mm	O.D.1 - O.D.2 mm
GRCR6-3	GRCG6-3	6 - 3	150-80	168,3 - 88,9
GRCR6-4	GRCG6-4	6 - 4	150-100	168,3 - 114,3
GRCR6-5	GRCG6-5	6 - 5	150-125	168,3 - 139,7
GRCR8-2½*	GRCG8-2½*	8 - 2½	200-65	219,1 - 76,1
GRCR8-3*	GRCG8-3*	8 - 3	200-80	219,1 - 88,9
GRCR8-4*	GRCG8-4*	8 - 4	200-100	219,1 - 114,3
GRCR8-5*	GRCG8-5*	8 - 5	200-125	219,1 - 139,7
GRCR8-6	GRCG8-6	8 - 6	200-150	219,1 - 168,3
GRCR10-4*	GRCG10-4*	10 - 4	250-100	219,1 - 114,3
GRCR10-5*	GRCG10-5*	10 - 5	250-125	219,1 - 139,7
GRCR10-6*	GRCG10-6*	10 - 6	250-150	273,0 - 168,3
GRCR10-8*	GRCG10-8*	10 - 8	250-200	273,0 - 219,1
GRCR12-4*	GRCG12-4*	12 - 4	300-100	323,9 - 114,3
GRCR12-6*	GRCG12-6*	12 - 6	300-150	323,9 - 168,3
GRCR12-8*	GRCG12-8*	12 - 8	300-200	323,9 - 219,1
GRCR12-10*	GRCG12-10*	12 - 10	300-250	323,9 - 273,0

* ONLY AVAILABLE IN CONTAINER DIRECTLY FROM FACTORY.

The following sizes are also available on request, in container:
73mm / 88,9mm / 114,3mm / 141,3mm / 165,1mm / 168,3mm / 219,1mm / 273mm / 323,9mm.

MATERIAL

- **Housing:** ductile iron conform to ASTM A536 GR 65-45-12.
- **Coating:**
 - Hot dip galvanized.
 - Red paint coating RAL 3000, EPD Epoxy coating.





THREADED CONCENTRIC REDUCER • GRCD



Threaded concentric reducers GRCD provide an economical and efficient method of reducing threaded piping systems.

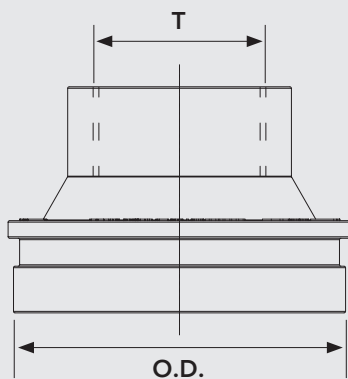
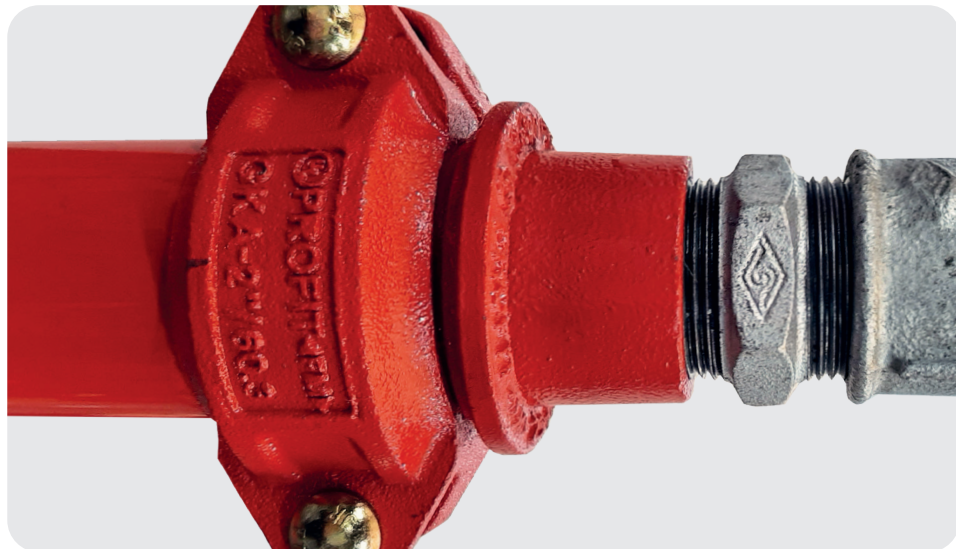

Reference		Nominal size		Pipe Ø O.D. - T
Red	Galva	NPS inch	DN mm	mm - inch
GRCDR1¼-1	GRCDG1¼-1	1¼ - 1	32	42,4 - 1
GRCDR1½-1	GRCDG1½-1	1½ - 1	40	48,3 - 1
GRCDR1½-1¼	GRCDG1½-1¼	1½ - 1¼	40	48,3 - 1¼
GRCDR2-1	GRCDG2-1	2 - 1	50	60,3 - 1
GRCDR2-1¼	GRCDG2-1¼	2 - 1¼	50	60,3 - 1¼
GRCDR2-1½	GRCDG2-1½	2 - 1½	50	60,3 - 1½
GRCDR2½-1	GRCDG2½-1	2½ - 1	65	76,1 - 1
GRCDR2½-1¼	GRCDG2½-1¼	2½ - 1¼	65	76,1 - 1¼
GRCDR2½-1½	GRCDG2½-1½	2½ - 1½	65	76,1 - 1½
GRCDR2½-2	GRCDG2½-2	2½ - 2	65	76,1 - 2
GRCDR3-1	GRCDG3-1	3 - 1	80	88,9 - 1
GRCDR3-1¼	GRCDG3-1¼	3 - 1¼	80	88,9 - 1¼
GRCDR3-1½	GRCDG3-1½	3 - 1½	80	88,9 - 1½
GRCDR3-2	GRCDG3-2	3 - 2	80	88,9 - 2
GRCDR3-2½	GRCDG3-2½	3 - 2½	80	88,9 - 2½
GRCDR4-1	GRCDG4-1	4 - 1	100	114,3 - 1
GRCDR4-1¼	GRCDG4-1¼	4 - 1¼	100	114,3 - 1¼
GRCDR4-1½	GRCDG4-1½	4 - 1½	100	114,3 - 1½
GRCDR4-2	GRCDG4-2	4 - 2	100	114,3 - 2
GRCDR4-2½	GRCDG4-2½	4 - 2½	100	114,3 - 2½
GRCDR4-3	GRCDG4-3	4 - 3	100	114,3 - 3
GRCDR5-1	GRCDG5-1	5 - 1	125	139,7 - 1
GRCDR5-1¼	GRCDG5-1¼	5 - 1¼	125	139,7 - 1¼
GRCDR5-1½	GRCDG5-1½	5 - 1½	125	139,7 - 1½
GRCDR5-2	GRCDG5-2	5 - 2	125	139,7 - 2



THREADED CONCENTRIC REDUCER • GRCD



DATASHEET

Threaded concentric reducers GRCD provide an economical and efficient method of reducing threaded piping systems.

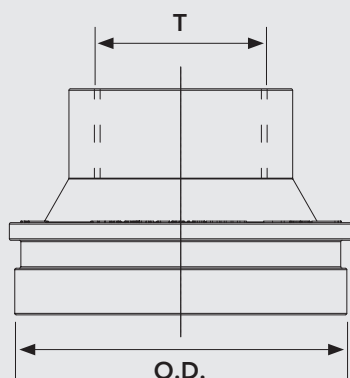

Reference		Nominal size		Pipe Ø O.D. - T
Red	Galva	NPS inch	DN mm	mm - inch
GRCDR5-2½	GRCDG5-2½	5 - 2½	125	139,7 - 2½
GRCDR5-3	GRCDG5-3	5 - 3	125	139,7 - 3
GRCDR5-4	GRCDG5-4	5 - 4	125	139,7 - 4
GRCDR6-1	GRCDG6-1	6 - 1	150	168,3 - 1
GRCDR6-1¼	GRCDG6-1¼	6 - 1¼	150	168,3 - 1¼
GRCDR6-1½	GRCDG6-1½	6 - 1½	150	168,3 - 1½
GRCDR6-2	GRCDG6-2	6 - 2	150	168,3 - 2
GRCDR6-2½	GRCDG6-2½	6 - 2½	150	168,3 - 2½
GRCDR6-3	GRCDG6-3	6 - 3	150	168,3 - 3
GRCDR6-4	GRCDG6-4	6 - 4	150	168,3 - 4
GRCDR8-1	GRCDG8-1	8 - 1	200	219,1 - 1
GRCDR8-1¼	GRCDG8-1¼	8 - 1¼	200	219,1 - 1¼
GRCDR8-1½	GRCDG8-1½	8 - 1½	200	219,1 - 1½
GRCDR8-2	GRCDG8-2	8 - 2	200	219,1 - 2
GRCDR8-2½	GRCDG8-2½	8 - 2½	200	219,1 - 2½
GRCDR8-3	GRCDG8-3	8 - 3	200	219,1 - 3
GRCDR8-4	GRCDG8-4	8 - 4	200	219,1 - 4

The following sizes are also available on request, in container:
73mm / 88,9mm / 114,3mm / 141,3mm / 165,1mm / 168,3mm / 219,1mm.

MATERIAL

- Housing: ductile iron conform to ASTM A536 GR 65-45-12
- Coating:
 - Hot dip galvanized
 - Red paint coating RAL 3000, EPD Epoxy coating



GROOVED REDUCING TEE • GRT



Grooved reducing tees GRT provide an economical and efficient method of adding a reduced grooved branch connection.

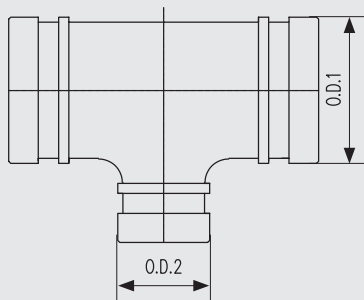

Reference		Nominal size		Pipe Ø O.D.
Red	Galva	NPS inch	DN mm	O.D.1 - O.D.2 mm
GRTR2-1	GRTG2-1	2 - 1	50 x 25	60,3 - 33,7
GRTR2-1¼	GRTG2-1¼	2 - 1¼	50 x 32	60,3 - 42,4
GRTR2-1½	GRTG2-1½	2 - 1½	50 x 40	60,3 - 48,3
GRTR2½-1¼	GRTG2½-1¼	2½ - 1¼	65 x 32	76,1 - 42,4
GRTR2½-1½	GRTG2½-1½	2½ - 1½	65 x 40	76,1 - 48,3
GRTR2½-2	GRTG2½-2	2½ - 2	65 x 50	76,1 - 60,3
GRTR3-1¼	GRTG3-1¼	3 - 1¼	80 x 32	88,9 - 42,4
GRTR3-1½	GRTG3-1½	3 - 1½	80 x 40	88,9 - 48,3
GRTR3-2	GRTG3-2	3 - 2	80 x 50	88,9 - 60,3
GRTR3-2½	GRTG3-2½	3 - 2½	80 x 65	88,9 - 76,1
GRTR4-2	GRTG4-2	4 - 2	100 x 50	114,3 - 60,3
GRTR4-2½	GRTG4-2½	4 - 2½	100 x 65	114,3 - 76,1
GRTR4-3	GRTG4-3	4 - 3	100 x 80	114,3 - 88,9
GRTR5-2	GRTG5-2	5 - 2	125 x 50	139,7 - 60,3
GRTR5-2½	GRTG5-2½	5 - 2½	125 x 65	139,7 - 76,1
GRTR5-3	GRTG5-3	5 - 3	125 x 80	139,7 - 88,9
GRTR5-4	GRTG5-4	5 - 4	125 x 100	139,7 - 114,3
GRTR6-2	GRTG6-2	6 - 2	150 x 50	168,3 - 60,3
GRTR6-2½	GRTG6-2½	6 - 2½	150 x 65	168,3 - 76,1
GRTR6-3	GRTG6-3	6 - 3	150 x 80	168,3 - 88,9
GRTR6-4	GRTG6-4	6 - 4	150 x 100	168,3 - 114,3
GRTR6-5	GRTG6-5	6 - 5	150 x 125	168,3 - 139,7
GRTR8-2½	GRTG8-2½	8 - 2½	200 x 65	219,1 - 76,1
GRTR8-3	GRTG8-3	8 - 3	200 x 80	219,1 - 88,9
GRTR8-4	GRTG8-4	8 - 4	200 x 100	219,1 - 114,3
GRTR8-5	GRTG8-5	8 - 5	200 x 125	219,1 - 139,7





GROOVED REDUCING TEE • GRT



DATASHEET

Grooved reducing tees GRT provide an economical and efficient method of adding a reduced grooved branch connection.

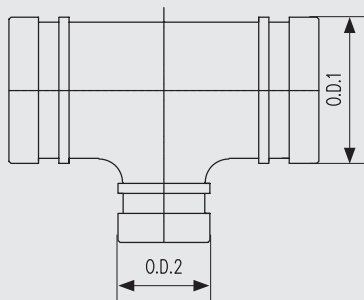

Reference		Nominal size		Pipe Ø O.D.
Red	Galva	NPS inch	DN mm	O.D.1 - O.D.2 mm
GRTR8-6	GRTG8-6	8 - 6	200 x 150	219,1 - 168,3
GRTR10-4	GRTG10-4	10 - 4	250 x 100	273,0 - 114,3
GRTR10-6	GRTG10-6	10 - 6	250 x 150	273,0 - 168,3
GRTR10-8	GRTG10-8	10 - 8	250 x 200	273,0 - 219,1
GRTR12-4	GRTG12-4	12 - 4	300 x 100	323,9 - 114,3
GRTR12-6	GRTG12-6	12 - 6	300 x 150	323,9 - 168,3
GRTR12-8	GRTG12-8	12 - 8	300 x 200	323,9 - 219,1
GRTR12-10	GRTG12-10	12 - 10	300 x 250	323,9 - 273,0

The following sizes are also available on request, in container:

73mm / 88,9mm / 114,3mm / 141,3mm / 165,1mm / 168,3mm / 219,1mm / 273mm / 323,9mm.

MATERIAL

- **Housing:** ductile iron conform to ASTM A536 GR 65-45-12.
- **Coating:**
 - Hot dip galvanized.
 - Red paint coating RAL 3000, EPD Epoxy coating.





THREADED REDUCING TEE • GRTD



Threaded reducing tees GRTD provide an economical and efficient method of adding a reduced threaded branch connection.

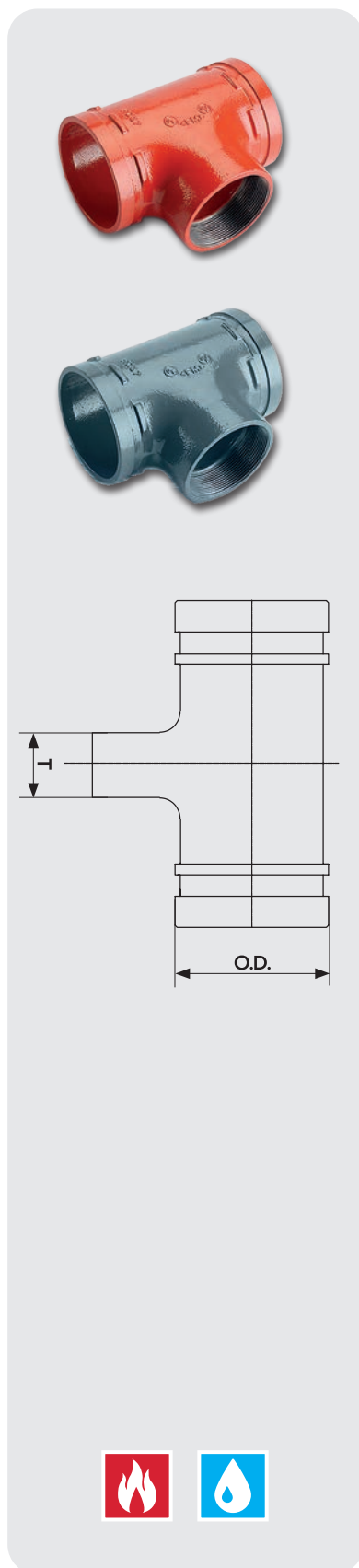

Reference		Nominal size		Pipe Ø O.D. - T
Red	Galva	NPS inch	DN mm	mm - inch
GRTDR2-1	GRTDG2-1	2 - 1	50-25	60,3 - 1
GRTDR2-1¼	GRTDG2-1¼	2 - 1¼	50-32	60,3 - 1¼
GRTDR2-1½	GRTDG2-1½	2 - 1½	50-40	60,3 - 1½
GRTDR2½-1	GRTDG2½-1	2½ - 1	65-25	76,1 - 1
GRTDR2½-1¼	GRTDG2½-1¼	2½ - 1¼	65-32	76,1 - 1¼
GRTDR2½-1½	GRTDG2½-1½	2½ - 1½	65-40	76,1 - 1½
GRTDR2½-2	GRTDG2½-2	2½ - 2	65-50	76,1 - 2
GRTDR3-1	GRTDG3-1	3 - 1	80-25	88,9 - 1
GRTDR3-1¼	GRTDG3-1¼	3 - 1¼	80-32	88,9 - 1¼
GRTDR3-1½	GRTDG3-1½	3 - 1½	80-40	88,9 - 1½
GRTDR3-2	GRTDG3-2	3 - 2	80-50	88,9 - 2
GRTDR3-2½	GRTDG3-2½	3 - 2½	80-65	88,9 - 2½
GRTDR4-1	GRTDG4-1	4 - 1	100-25	114,3 - 1
GRTDR4-1¼	GRTDG4-1¼	4 - 1¼	100-32	114,3 - 1¼
GRTDR4-1½	GRTDG4-1½	4 - 1½	100-40	114,3 - 1½
GRTDR4-2	GRTDG4-2	4 - 2	100-50	114,3 - 2
GRTDR4-2½	GRTDG4-2½	4 - 2½	100-65	114,3 - 2½
GRTDR5-1¼	GRTDG5-1¼	5 - 1¼	125-32	139,7 - 1¼
GRTDR5-1½	GRTDG5-1½	5 - 1½	125-40	139,7 - 1½
GRTDR5-2	GRTDG5-2	5 - 2	125-50	139,7 - 2
GRTDR5-2½	GRTDG5-2½	5 - 2½	125-65	139,7 - 2½
GRTDR5-3	GRTDG5-3	5 - 3	125-80	139,7 - 3
GRTDR6-1½	GRTDG6-1½	6 - 1½	150-40	168,3 - 1½
GRTDR6-2	GRTDG6-2	6 - 2	150-50	168,3 - 2
GRTDR6-2½	GRTDG6-2½	6 - 2½	150-65	168,3 - 2½
GRTDR6-3	GRTDG6-3	6 - 3	150-80	168,3 - 3



THREADED REDUCING TEE • GRTD



DATASHEET

Threaded reducing tees GRTD provide an economical and efficient method of adding a reduced threaded branch connection.



Reference		Nominal size		Pipe Ø O.D. - T
Red	Galva	NPS inch	DN mm	mm - inch
GRTDR8-2	GRTDG8-2	8 - 2	200-50	219,1 - 2
GRTDR8-2½	GRTDG8-2½	8 - 2½	200-65	219,1 - 2½
GRTDR8-3	GRTDG8-3	8 - 3	200-80	219,1 - 3
GRTDR8-4	GRTDG8-4	8 - 4	200-100	219,1 - 4

The following sizes are also available on request, in container:
73mm / 88,9mm / 114,3mm / 141,3mm / 165,1mm / 168,3mm / 219,1mm.

MATERIAL

- **Housing:** ductile iron conform to ASTM A536 GR 65-45-12
- **Coating:**
 - Hot dip galvanized
 - Red paint coating RAL 3000, EPD Epoxy coating

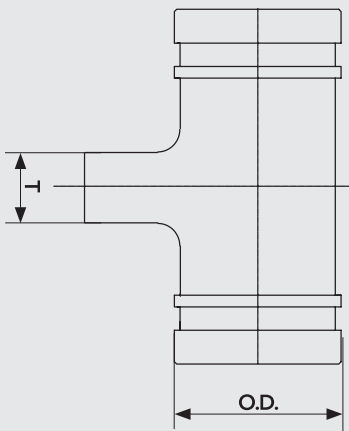

GROOVED END CAP • GE



DATASHEET

Grooved end caps GE provide an economical and efficient method of capping grooved piping systems.

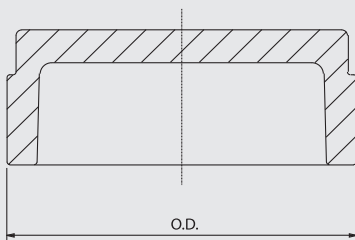
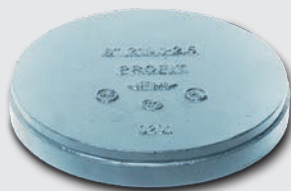

Reference		Nominal size		Pipe Ø O.D.
Red	Galva	NPS inch	DN mm	mm
GER1	GEG1	1	25	33,7
GER1¼	GEG1¼	1¼	32	42,4
GER1½	GEG1½	1½	40	48,3
GER2	GEG2	2	50	60,3
GER2½	GEG2½	2½	65	76,1
GER3	GEG3	3	80	88,9
GER4	GEG4	4	100	114,3
GER5	GEG5	5	125	139,7
GER6	GEG6	6	150	168,3
GER8	GEG8	8	200	219,1
GER10	GEG10	10	250	273,0
GER12*	GEG12*	12	300	323,9

* ONLY AVAILABLE IN CONTAINER DIRECTLY FROM FACTORY.

The following sizes are also available on request, in container: 73mm / 141,3mm / 165,1mm.

MATERIAL

- **Housing:** ductile iron conform to ASTM A536 GR 65-45-12.
- **Coating:**
 - Hot dip galvanized.
 - Red paint coating RAL 3000, EPD Epoxy coating.



GROOVED END CAP WITH ECCENTRIC HOLE • GE



DATASHEET

Grooved end caps GE with threaded BSPT eccentric holes provide an economical and efficient method of reducing grooved piping systems. **With threaded BSPT outlet.**

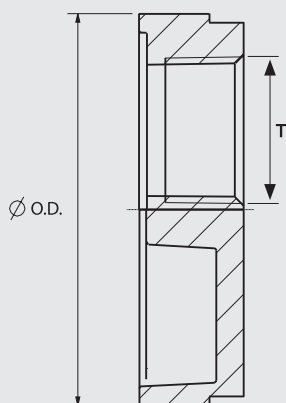

Reference		Nominal size		Pipe Ø O.D. - T
Red	Galva	NPS inch	DN mm	mm - inch
GER2-1	GEG2-1	2 - 1	50 - 25	60,3 - 1
GER2-1¼*	GEG2-1¼*	2 - 1¼	50 - 32	60,3 - 1¼
GER2-1½	GEG2-1½	2 - 1½	50 - 40	60,3 - 1½
GER2½-1	GEG2½-1	2½ - 1	65 - 25	76,1 - 1
GER2½-1¼	GEG2½-1¼	2½ - 1¼	65 - 32	76,1 - 1¼
GER2½-1½	GEG2½-1½	2½ - 1½	65 - 40	76,1 - 1½
GER2½-2	GEG2½-2	2½ - 2	65 - 50	76,1 - 2
GER3-1	GEG3-1	3 - 1	80 - 25	88,9 - 1
GER3-1¼	GEG3-1¼	3 - 1¼	80 - 32	88,9 - 1¼
GER3-1½	GEG3-1½	3 - 1½	80 - 40	88,9 - 1½
GER3-2	GEG3-2	3 - 2	80 - 50	88,9 - 2
GER4-1¼*	GEG4-1¼*	4 - 1¼	100 - 32	114,3 - 1¼
GER4-1½*	GEG4-1½*	4 - 1½	100 - 40	114,3 - 1½
GER4-2	GEG4-2	4 - 2	100 - 50	114,3 - 2
GER5-2	GEG5-2	5 - 2	125 - 50	139,7 - 2
GER6-2	GEG6-2	6 - 2	150 - 50	168,3 - 2
GER8-2	GEG8-2	8 - 2	200 - 50	219,1 - 2

* ONLY AVAILABLE IN CONTAINER DIRECTLY FROM FACTORY.

The following sizes are also available on request, in container: 73mm / 141,3mm / 165,1mm.

MATERIAL

- **Housing:** ductile iron conform to ASTM A536 GR 65-45-12.
- **Coating:**
 - Hot dip galvanized.
 - Red paint coating RAL 3000, EPD Epoxy coating.



GROOVED ADAPTER FLANGE • GAF16



DATASHEET

Grooved adapter flanges GAF16 allow the connection between flanged and grooved end equipment.

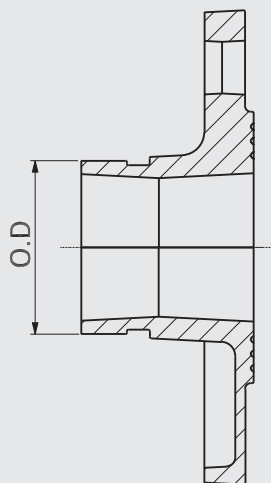

Reference		Nominal size		Pipe Ø O.D.
Red	Galva	NPS inch	DN mm	mm
GAF16R2	GAF16G2	2	50	60,3
GAF16R2½	GAF16G2½	2½	65	76,1
GAF16R3	GAF16G3	3	80	88,9
GAF16R4	GAF16G4	4	100	114,3
GAF16R5	GAF16G5	5	125	139,7
GAF16R6	GAF16G6	6	150	168,3
GAF16R8	GAF16G8	8	200	219,1
GAF16R10*	GAF16G10*	10	250	273,0
GAF16R12*	GAF16G12*	12	300	323,9

* ONLY AVAILABLE IN CONTAINER DIRECTLY FROM FACTORY.

The following sizes are also available on request, in container: 73mm / 141,3mm / 165,1mm.

MATERIAL

- **Housing:** ductile iron conform to ASTM A536 GR 65-45-12
- **Coating:**
 - Hot dip galvanized
 - Red paint coating RAL 3000, EPD Epoxy coating
- **Flange drilling:** EN 1092-PN16.



GROOVED SPLIT ADAPTER FLANGE • GSF16



DATASHEET

Grooved split adapter flanges GSF16 allow the connection between flanged and grooved end equipment.

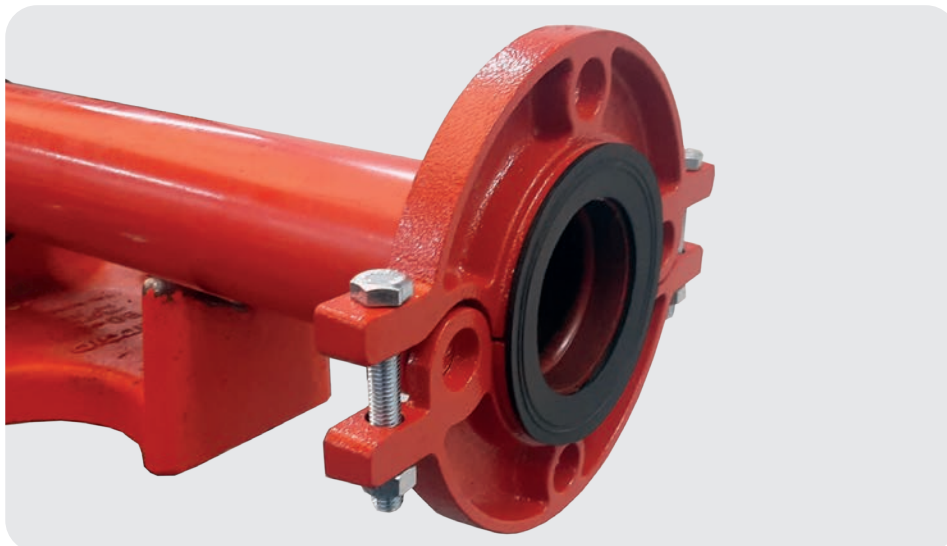
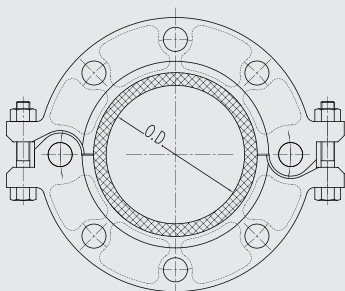
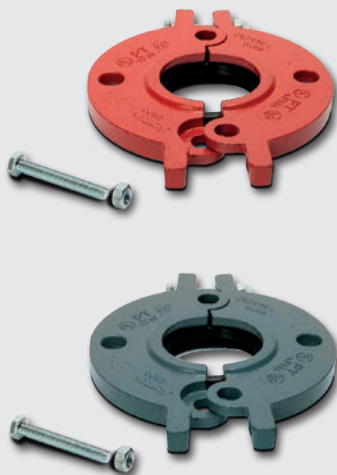

Reference		Nominal size		Pipe Ø O.D.
Red	Galva	NPS inch	DN mm	mm
GSF16R2	GSF16G2*	2	50	60,3
GSF16R2½	GSF16G2½*	2½	65	76,1
GSF16R3	GSF16G3*	3	80	88,9
GSF16R4	GSF16G4*	4	100	114,3
GSF16R5*	GSF16G5*	5	125	139,7
GSF16R6	GSF16G6*	6	150	168,3
GSF16R8	GSF16G8*	8	200	219,1

* ONLY AVAILABLE IN CONTAINER DIRECTLY FROM FACTORY.

The following sizes are also available on request, in container: 73mm / 141,3mm / 165,1mm.

MATERIAL

- **Housing:** ductile iron conform to ASTM A536 GR 65-45-12
- **Coating:**
 - Hot dip galvanized
 - Red paint coating RAL 3000, EPD Epoxy coating



GROOVED THREADED ADAPTER, MALE THREAD BSPT • NGA



DATASHEET

Nipple grooved adapters NGA allow the connection between male threaded and grooved end equipment.

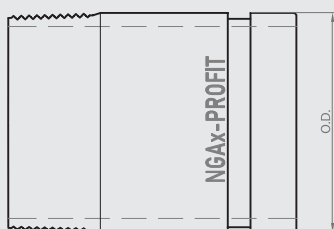
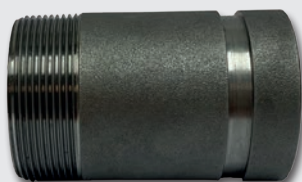

Reference		Nominal size		Pipe Ø O.D.
Black uncoated	Zinc electroplated	NPS inch	DN mm	mm
NGA1 - BLACK	NGA1 - GALVA	1	25	33,7
NGA1¼ - BLACK	NGA1¼ - GALVA	1¼	32	42,4
NGA1½ - BLACK	NGA1½ - GALVA	1½	40	48,3
NGA2 - BLACK	NGA2 - GALVA	2	50	60,3
NGA2½ - BLACK	NGA2½ - GALVA	2½	65	76,1
NGA3 - BLACK	NGA3 - GALVA	3	80	88,9
NGA4 - BLACK	NGA4 - GALVA	4	100	114,3

MATERIAL

- **Body:** carbon steel.
- **Surface finish:**
 - Black uncoated.
 - Zinc electroplated.
- Cutted grooved according AWWA C606.



GROOVED THREADED ADAPTER, FEMALE THREAD BSPT • SGA



DATASHEET

Socket grooved adapters SGA allow the connection between female threaded and grooved end equipment.

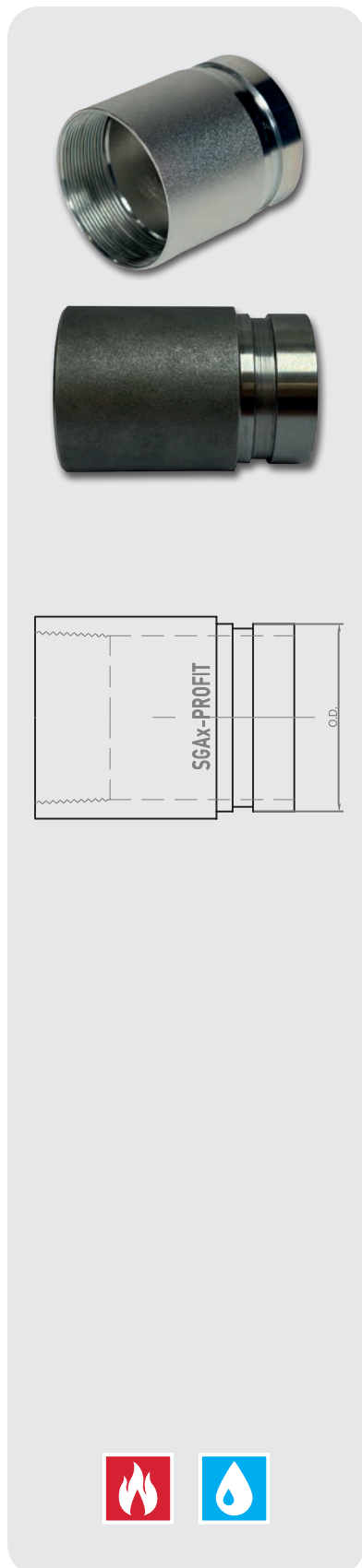

Reference		Nominal size		Pipe Ø O.D.
Black uncoated	Zinc electroplated	NPS inch	DN mm	mm
SGA1 - BLACK	SGA1 - GALVA	1	25	33,7
SGA1¼ - BLACK	SGA1¼ - GALVA	1¼	32	42,4
SGA1½ - BLACK	SGA1½ - GALVA	1½	40	48,3
SGA2 - BLACK	SGA2 - GALVA	2	50	60,3
SGA2½ - BLACK	SGA2½ - GALVA	2½	65	76,1
SGA3 - BLACK	SGA3 - GALVA	3	80	88,9
SGA4 - BLACK	SGA4 - GALVA	4	100	114,3

MATERIAL

- **Body:** carbon steel.
- **Surface finish:**
 - Black uncoated.
 - Zinc electroplated.
- Cutted grooved according AWWA C606.



MATERIALS



HOUSING & FITTING

Our standard housings and fittings are made of ductile iron conform to ASTM A-536, Grade 65-45-12. This material has a minimum tensile strength of 65.000 PSI (448MPa), a minimum yield strength of 45.000 PSI (310MPa) and minimum 12 % elongation.

- Brand marking: PROFIT or PT.

COATING

EPD Epoxy coating in RAL 3000 (red) or RAL 9010 (white*), or hot dip galvanized.

- Profit coated products are intended for indoor piping applications (EN 12944-2 corrosivity category C1&C2).
- For outdoor installations near the sea (corrosivity category C3) we advise to use our hot dip galvanized couplings and fittings.
- For application in higher salinity climate (corrosivity category C4) or higher, please contact info@profitings.eu.
- Profit couplings and fittings must be stored in closed and dry environments.



EPDM GASKETS

Profit's EPDM gaskets comply with the international certifications and have undergone the aging test at 110°C (230°F) during a period of 45 days (1080 hours). The gaskets have even undergone the freezing test at -40°C (-40°F) during a period of 4 days (96 hours).

- Compound: EPDM, silicon-free.
- Color: black.
- Brand marking: PROFIT.

PROFIT GASKET APPLICATION OVERVIEW

GASKET COMPOUND GRADE	REFERENCE CATALOGUE ITEM	TEMPERATURE RANGE (°C)	MEDIUM				
			Cold Water	Hot water	Air (oil-free)	Nitrogen	Glycol/ water mixtures
EPDM	GKS, GKF, GKA, GKRF, GSF	-40°C / +110°C	✓	✓	✓	✓	✓
EPDM	GMG, GST, GMD, GSTFC	-40°C / +110°C	✓	✓	✓	✓	✓

Note: please lubricate our gaskets with Prolube Extreme in conditions where temperature is higher than +45°C (HVAC) or lower than -30 °C (dry pipe, freezer application, HVAC).

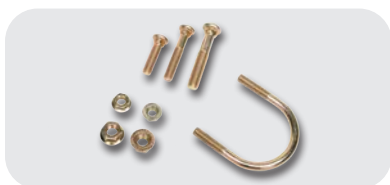

BOLTS AND NUTS

Heat resistant, zinc electroplated bolts and nuts made of carbon steel, conform to ASTM A183/ISO 898. Please check our technical data sheet for more information.

- Brand marking: PT.

Please observe the following procedures when using torque wrenches during installation of piping components on construction sites:

- 1) Make sure that the coupling housings are located in the pipe grooves and are over the lubricated gasket.
- 2) Insert bolts and run nuts finger tight.
- 3) Securely tighten nuts alternately and equally until fully tightened, keeping the gap at the bolt pad evenly spaced.

Note:

- Uneven tightening of bolts may damage the gasket.
- Lubricant should be applied at time of joint assembly.
- On piping installations operating at higher working pressures or within critical locations or environments, the use of a proprietary torque wrench is recommended.

*Other colours available on request

A collection of red firefighting equipment, including a nozzle and a glove, with the word 'ACCESSORIES' overlaid in a white box.

ACCESSORIES

LUBRICANT • PROLUBE XTREME

The best way to lubricate your coupling gaskets is by using Profit lubricant. PROLUBE XTREME is a high-end pure silicon oil lubricant, specially formulated to enable an easy and fast application in the most extreme conditions.



DATASHEET



Reference	Packaging	Content
Prolube Xtreme 900gr	Pot	900gr



- **Colour:** transparent-white.
- **Consistency:** pasta.
- **Temperature range:** -40°C up to +200°C.
- Moisture-repellent, insoluble in water.
- Thixotropic.



LUBRICANT • SUPER GLIDEX -30

The best way to lubricate your coupling gaskets is by using Profit lubricant. Super Glidex is high quality silicon oil based lubricant, specially formulated to enable an easy and fast application.



DATASHEET



Reference	Packaging	Content
Super Glidex-30 175gr	Applicator tube	175gr
Super Glidex-30 1000gr	Pot	1000gr



- **Colour:** snow-white.
- **Consistency:** creamy.
- **pH-value:** 6.5- 7.
- Water -soluble.
- Bio-degradable.



GROOVE METER

Pocket-sized tapes are for taking circumferential measurements.



Reference
Groove meter



- Range: ¾" – 24".
- Composition: steel.



GLOVES • SIZE 11



Profit industrial gloves are recommended for the installation of fire protection material. The gloves protect against mechanical risks and are manufactured in accordance to EN 388:2016.



Reference
Gloves size 11



- Composition: 15 gauge, spandex and nylon knitted liners, coated with nitrile and finished with a micro fine foam.



CENTER PUNCH TOOL

The Profit center punch tool is a level and square combination tool that improves precision in all circumstances. It's lightweight sleek design makes it easy to handle/carry and provides more functionality. Ultra-strong replaceable rare earth magnets provide a firm grip on pipes up to 10" in diameter.



DATASHEET



Reference

CP tool



- Easy to use.
- Suitable for pipes size: 1" up to 10".
- Two replacable rare-earth magnets included.
- Lifelong durability.



PRESSURE GAUGE



Profit pressure gauges type PG/0-25bar/FM are gauges designed and approved for use in fire sprinkler pipe systems. The model is based on the proven Bourdon tube measuring system.



DATASHEET



Reference

PG/0-25-1/4"-FM



- Can be used for medium water or air.
- Suitable for indoor and outdoor use, protection class IP44.
- Pressure element: Bourdon tube in copper alloy.
- Corrosion resistant casing.
- Accuracy class: class 1.6.





Piping Logistics bv

Industrielaan 27
9320 Erembodegem
Belgium

T: +32 (0)53 64 51 00

info@pipinglogistics.eu
www.pipinglogistics.eu

Follow us online:

